

## 5.10 Fixing Socket

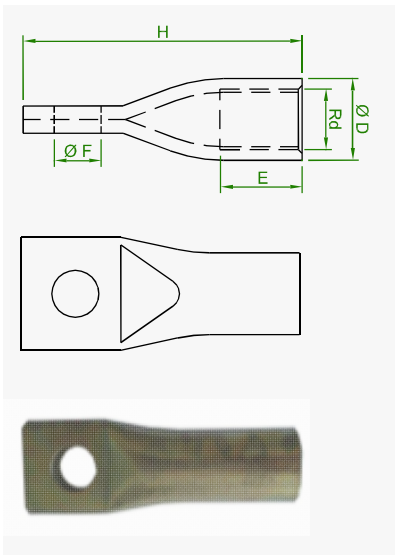

REFERENCE	THREAD M	SAFE WORKING LOAD [KG]				DIMENSIONS [MM]				WEIGHT [KG]
		0° - 45°	45° - 90°	Ø D	H	E	Ø F			
DTP 12M	12	500	250	15	60	22	10	0,031		
DTP 16M	16	1200	600	21	80	27	13	0,110		
DTP 20M	20	2000	1000	27	95	35	15	0,200		
DTP 24M	24	2500	1250	31	100	38	18	0,270		
DTP 30M	30	4000	2000	39,5	135	56	22,5	0,600		

A minimum concrete strength of 25 MPa is required for fixing.

A stirrup must be placed in the hole of the socket.

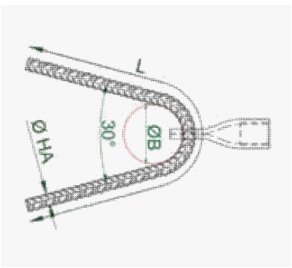

SOCKET	Ø HA BS008 [MM]	LENGTH OF THE STIRRUP L [MM]	BENDING ROLL ØB [MM]
DTP 12M	6	340	60
DTP 16M	10	510	100
DTP 20M	12	670	120
DTP 24M	14	740	140
DTP 30M	16	970	160

## 6. Holding Device

### 6.1 Plastic Nailing Plate

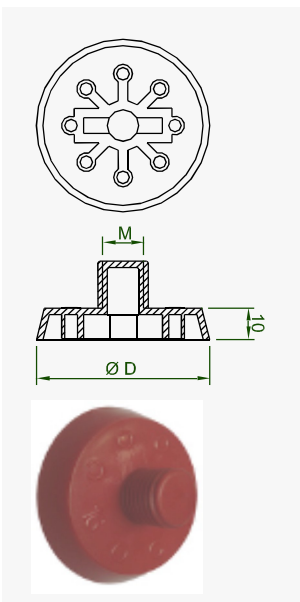

REFERENCE	THREAD M	DIMENSION [MM] Ø D	COLOR
PP 10	10	40	Blue
PP 12	12	40	Orange
PP 16	16	55	Red
PP 20	20	55	Light green
PP 24	24	55	Dark grey
PP 30	30	70	Dark green
PP 36	36	70	Light blue
PP 42	42	96	Light grey
PP 52	52	96	Yellow

The plastic holding discs are designed to be fixed to the mould with nails.

The plastic holding discs are convenient for:

- the lifting sockets (Round thread – Rd)
- the fixing sockets (Metric thread – M).  
They can be removed with a flat steel.