



CONSTRUCTION ACCESSORIES

Shuttering Strip DATASHEET

ESSENTIAL COMPONENTS FOR EVERY STAGE OF CONSTRUCTION



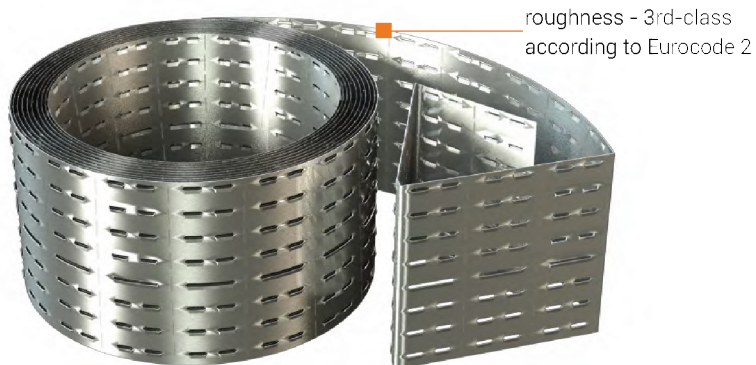

SF Tape can be also fitted in precast elements.

IMPORTANT: When cutting, include 5 cm overlap for tape connection.

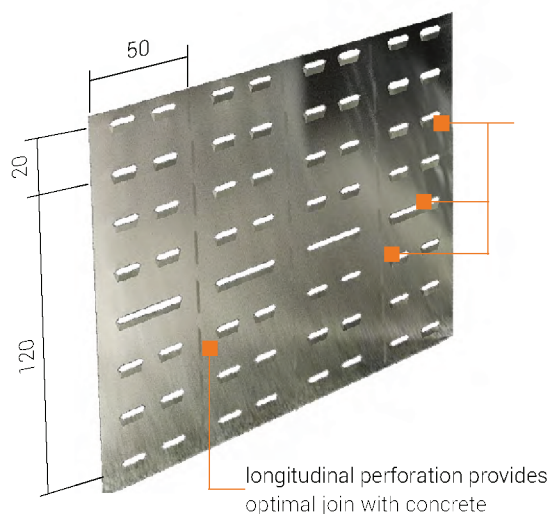

Standard lengths:

- rolls - L = 10.0 m
- flat tapes - L = 2.25 m

SF tape cut using simple tools



bending SF tape into the required shape

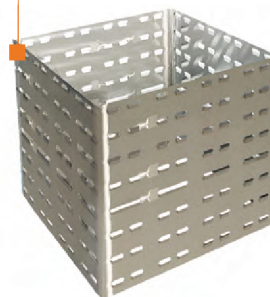

Tape is cross-perforated every 5 cm which allows the forming of different shapes.

ARTICLE NUMBER	TYPE	TAPE WIDTH [mm]	ROLLS [m]	FLAT TAPE [m]
520-14	SF 14	140	10	2.25
520-16	SF 16	160	10	2.25
520-18	SF 18	180	10	2.25
520-20	SF 20	200	10	2.25
520-22	SF 22	220	10	2.25
520-24	SF 24	240	10	2.25
520-25	SF 25	250	10	2.25
520-26	SF 26	260	10	2.25
520-28	SF 28	280	10	2.25
520-30	SF 30	300	10	2.25

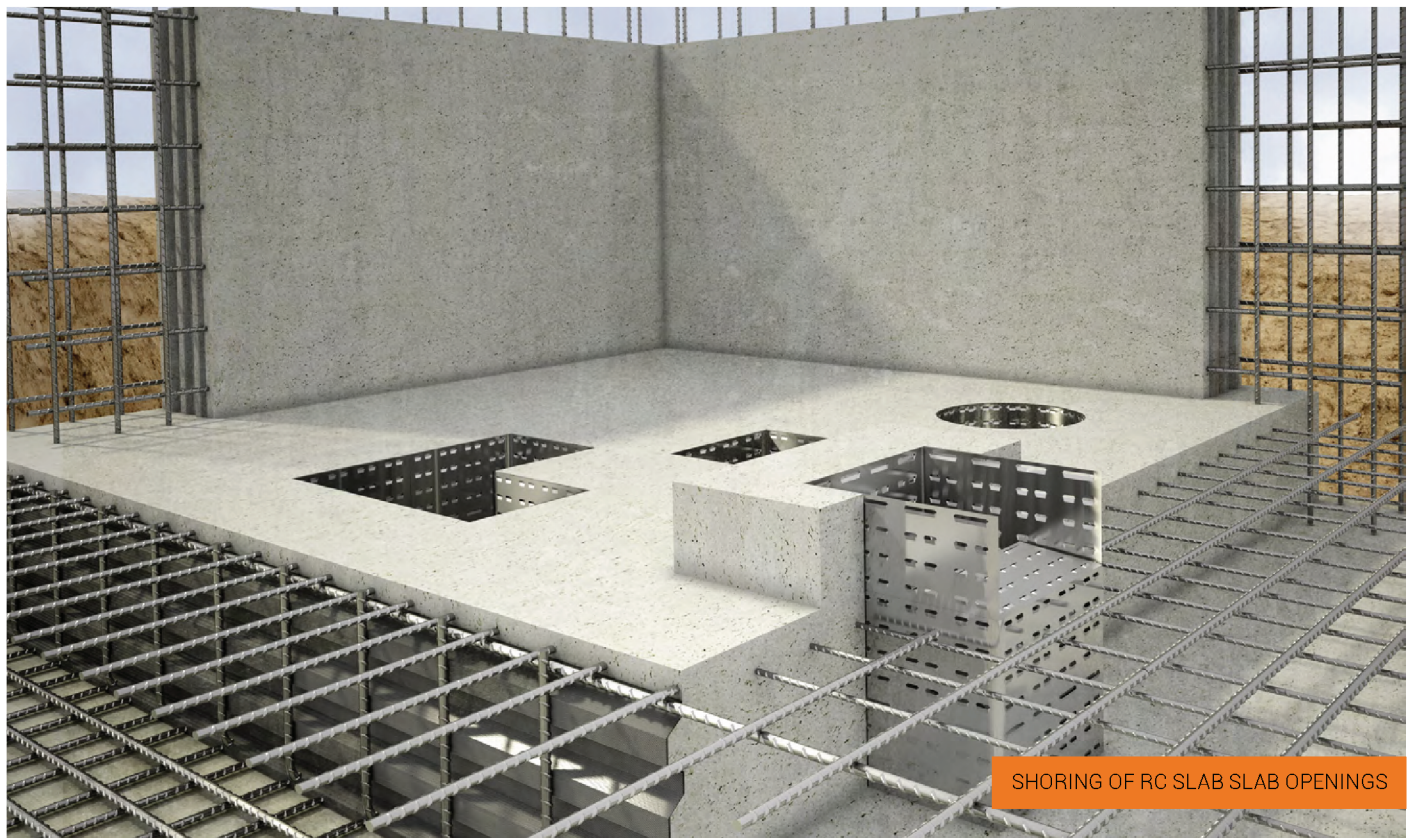
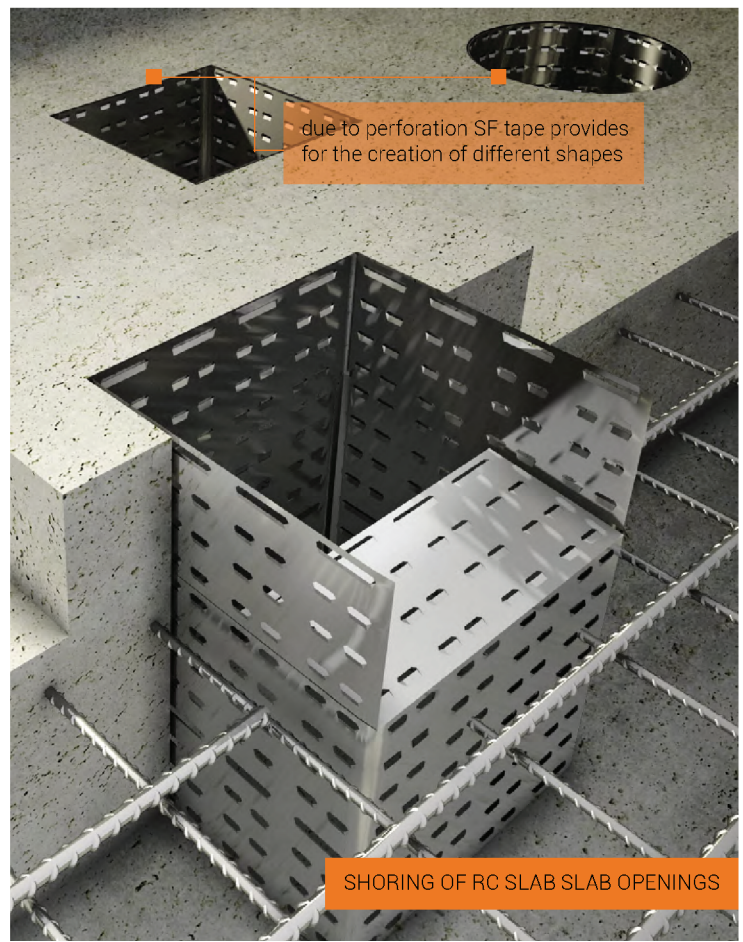
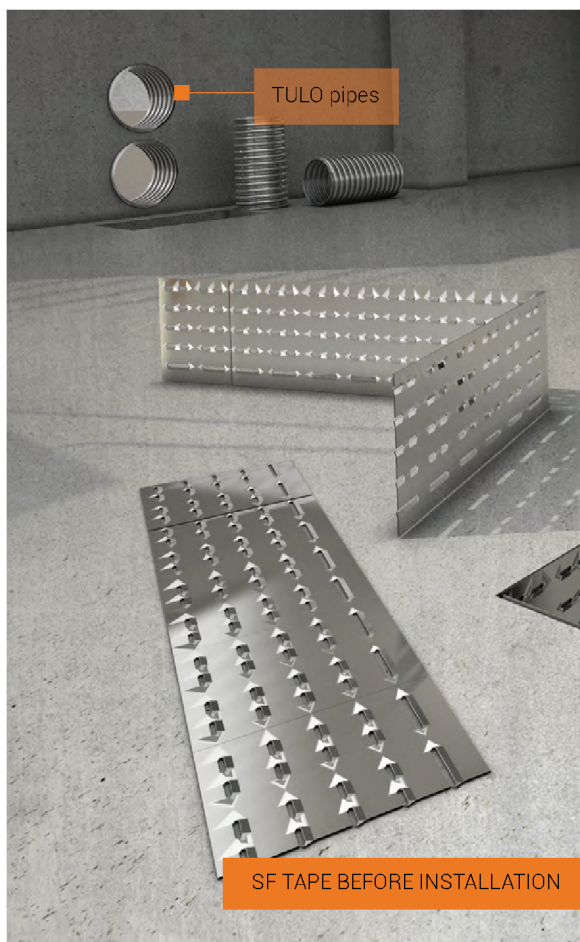

The logo consists of the letters 'SDG' in a bold, sans-serif font. The 'S' and 'D' are connected, and the 'G' is slightly separated. The color is a light gray or off-white, contrasting with the dark teal background.

Get in touch

HEAD OFFICE

21 Tullygoonigan Industrial Estate
Moy Road
Armagh
BT61 8DR

Tel: +44 (0) 28 3752 8999

sdgconstructiontechnology.com

MONAGHAN OFFICE

Cornacrieve
Emyvale
Monaghan
HY18 XY 46

Tel: + 353 (47) 87 295

Email: sales@sdg.ie