

SDG

—
STRONGER
TOGETHER
—

Product Catalogue

ESSENTIAL COMPONENTS FOR EVERY STAGE OF CONSTRUCTION



Welcome to SDG.

Your essential
construction partner.

Stronger, together.

We work with manufacturers, contractors, engineers and designers, supplying essential components that improve safety, enhance quality and drive efficiency at every stage of construction.

At SDG we are trusted suppliers, and experts in construction solutions. We are planners, collaborators and designers; fixers, thinkers and expert problem solvers. We're an end-to-end construction project partner, bespoke and best in class. By working closely with our customers; by adding value at every stage; by doing everything they expect and so much more, we share their success and become stronger, together.



TECHNICAL INNOVATION



PRECAST ACCESSORIES



CONSTRUCTION ACCESSORIES



WATERPROOFING



ACOUSTICS



Construction Accessories

Contact our sales team:
wearesdg.com
+44 (0) 28 3752 8999

SECTION CONTENTS

Starter Packs & Rebar Connection Couplers	232
Formwork Accessories	242
Expansion Joint Materials	261
Permanent Formwork	262
Safety Systems	263
Concrete Deck & Wall Spacers	264
Construction Grouts, Mortars & Release Agents	276
Joint Sealants	294
SCP Tanking Membranes	298
Waterstops	302
Concrete Testing Equipment	307
Formwork Solutions	309
Masonry Reinforcement	311
Acoustic Impact Sound Insulation	312

recostal® Standard Type RSH Starter Packs

recostal® Starter Packs type RSH meet the requirements of DIN EN 1992-1-1 for the highest surface category "key profiled" in the case of transverse loads.

The deciding factor for the designer

recostal® Starter Packs type RSH meet the requirements of the DBV Bulletin "Rückbiegen von Betonstahl und Anforderungen an Verwahrkästen nach Eurocode 2" ["Rebending of reinforcement steel and requirements for continuity strips according to Eurocode 2"] (issue January 2011) for the highest joint category "key profiled" in the case of transverse stresses. No national approval required!

Technical data – RSH Starter Packs

- Trapezoidally profiled starter packs, joint category "key profiled" according to DIN EN 1992-1-1, highest shear force bearing capacity
- Concrete reinforcement steel according to BS EN ISO 17660 and BS8548

- 6 standard profiles, bar widths 12 cm – 22 cm, smaller or larger bar widths on request
- Standard unit length L= 1.25 m, fixed lengths up to 2.50 m on request

Application

recostal® Starter Packs ensure time-saving installation of secure connections between steel reinforced concrete construction parts that are created with different pour sequences. Therefore, floor slabs, walls or staircases can be installed subsequently with rigid connections corresponding to the highest joint category "key profiled".

The large variety of shapes offers the perfect connection for many different design situations; special types for specific solutions are also available. The standard range includes starter packs with 12mm and 16mm diameter and L=1.25m unit lengths. Unit lengths exceeding 1.25m, the production of special types and the combination with waterproofing systems as well as solutions for entire projects are possible on request.

Advantages:

- Strong, robust galvanised sheet metal starter packs, dimensionally stable
- Cost and time effective installation, starter packs are simply nailed to the formwork
- Easy removal of the sheet metal covers due to their special design
- Trapezoidally profiled box for excellent bond
- Various possible combinations provide a solution for all common installation details



Increased corrosion protection

Type RSH is installed with a planned 25 mm recess



Key Profile

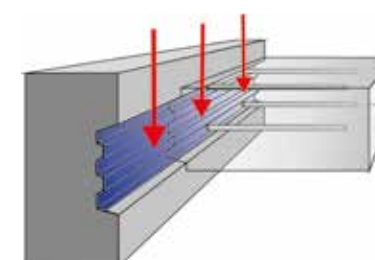

RSH active - Starter Pack with active waterproofing

RSH Starter Packs can be manufactured with an active bentonite coating on both sides for the application in construction joints exposed to water.

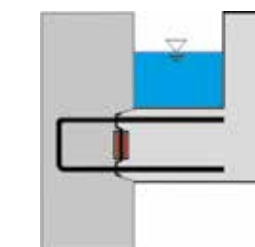

recostal® Standard Type RSH Starter Packs

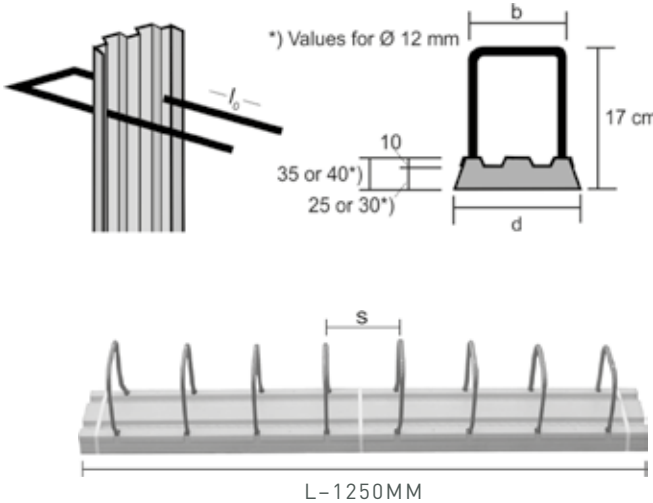

DIMENSIONS	PRODUCT CODE	TYPE	BAR Ø (MM)	CENTRES	LAP LENGTH (MM) L	WIDTH OF STIRRUP (MM) B	WIDTH OF CASING (MM) D
<div>T12</div>	EUR008	RSH 100	12	150	500	100	120
	EUR009		12	200	500	100	
<div>T12</div>	EUR010	RSH 120	12	150	500	120	140
	EUR011		12	200	500	120	140
<div>T12</div>	EUR012	RSH 140	12	150	500	140	170
	EUR013		12	200	500	140	170

DIMENSIONS	PRODUCT CODE	TYPE	BAR Ø (MM)	CENTRES	LAP LENGTH (MM) L	WIDTH OF STIRRUP (MM) B	WIDTH OF CASING (MM) D
<div>T12</div>	EUR014	RSH 160	12	150	500	160	190
	EUR015		12	200	500	160	190
<div>T16</div>	EUR040		16	150	650	160	190
	EUR041		16	200	650	160	190
<div>T12</div>	EUR016	RSH 180	12	150	500	180	210
	EUR017		12	200	500	180	210
<div>T16</div>	EUR042		16	150	650	180	210
	EUR043		16	200	650	180	210
<div>T12</div>	EUR018	RSH 200	12	150	500	200	230
	EUR019		12	200	500	200	230
<div>T16</div>	EUR044		16	150	650	200	230
	EUR045		16	200	650	200	230
<div>T12</div>	EUR020	RSH 220	12	150	500	220	250
	EUR021		12	200	500	220	250
<div>T16</div>	EUR046		16	150	650	220	250
	EUR047		16	200	650	220	250

recostal® Standard Type VHQ Starter Packs



STANDARD	PRODUCT CODE	Ø (MM)/ S (CM)	LAP LENGTH L (CM)	CENTRES S (CM)
	EUR001	- 12/15	50	15
	EUR002	- 12/20	50	20
	EUR003	- 16/15	65	15
	EUR004	- 16/20	65	20

Graph for the determination of the production-related required box widths and max. producible l0-lengths

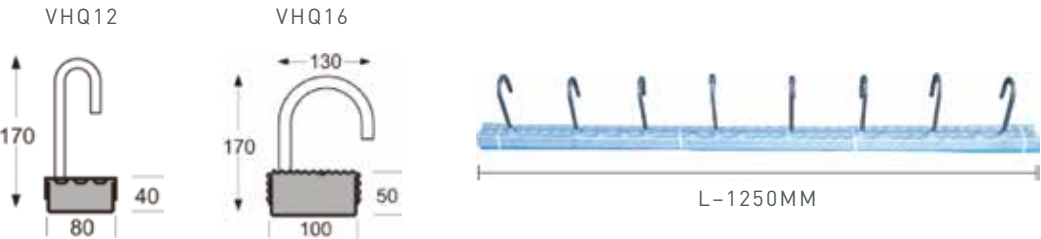

SPECIAL SHAPE CODES AVAILABLE.
CONTACT OUR TECHNICAL DEPARTMENT FOR MORE INFORMATION.

SHQ

SB

SKB

SWQ

2SH

SKG

SG

SRG

SKR

SR

Female Couplers

This is the cast in part of the system, it comprises a socket swaged onto a high yield reinforcement bar. The socket area is larger than the bar ensuring that the bar itself is the weakest part of the coupler. Also available in Stainless Steel.



PRODUCT CODE	LENGTH (MM)	THREAD DIMENSIONS		COUPLER DIMENSIONS		BAR DIA. (MM)	REINFORCEMENT STEEL	
		METRIC (M)	LENGTH (MM)	WIDTH (MM)	LENGTH (MM)		TENSILE FORCE (KN)	RATED SECTION (MM²)
PSG120400	400	16	25	22	62	12	56.5	113.0
PSG120600	600	16	25	22	62	12	56.5	113.0
PSG120800	800	16	25	22	62	12	56.5	113.0
PSG121500	1500	16	25	22	62	12	56.5	113.0
PSG160400	400	20	38	27	86	16	100.5	201.0
PSG160550	550	20	38	27	86	16	100.5	201.0
PSG160800	800	20	38	27	86	16	100.5	201.0
PSG161020	1020	20	38	27	86	16	100.5	201.0
PSG161440	1440	20	38	27	86	16	100.5	201.0
PSG200700	700	24	42	34	99	20	157.0	314.0
PSG201000	1000	24	42	34	99	20	157.0	314.0
PSG201280	1280	24	42	34	99	20	157.0	314.0
PSG201800	1800	24	42	34	99	20	157.0	314.0
PSG202000	2000	24	42	34	99	20	157.0	314.0
PSG202200	2200	24	42	34	99	20	157.0	314.0
PSG250700	700	30	52	41	117	25	245.5	491.0
PSG251000	1000	30	52	41	117	25	245.5	491.0
PSG251500	1500	30	52	41	117	25	245.5	491.0
PSG252260	2260	30	52	41	117	25	245.5	491.0
PSG321400	1400	42	65	54	153	32	401.9	803.8
PSG322300	2300	42	65	54	153	32	401.9	803.8
PSG401000	1000	48	72	64	188	40	625.0	1250.0
PSG401500	1500	48	72	64	188	40	625.0	1250.0
PSG402000	2000	48	72	64	188	40	625.0	1250.0

Male Couplers

This is the screw in coupler. It has an enlarged threaded end to maximize the bar strength.



PRODUCT CODE	LENGTH (MM)	THREAD DIMENSIONS		BAR DIA. (MM)	REINFORCEMENT STEEL	
		METRIC (M)	LENGTH (MM)		TENSILE FORCE (KN)	RATED SECTION (MM²)
TSE120200	200	16	22	12	56.5	113.0
TSE120375	375	16	22	12	56.5	113.0
TSE120575	575	16	22	12	56.5	113.0
TSE120800	800	16	22	12	56.5	113.0
TSE121000	1000	16	22	12	56.5	113.0
TSE121500	1500	16	22	12	56.5	113.0
TSE122000	2000	16	22	12	56.5	113.0
TSE160520	520	20	28	16	100.5	201.0
TSE160770	770	20	28	16	100.5	201.0
TSE161020	1020	20	28	16	100.5	201.0
TSE161250	1250	20	28	16	100.5	201.0
TSE161440	1440	20	28	16	100.5	201.0
TSE162200	2200	20	28	16	100.5	201.0
TSE161250	1250	20	28	16	100.5	201.0
TSE200665	665	24	35	20	157.0	314.0
TSE200965	965	24	35	20	157.0	314.0
TSE201280	1280	24	35	20	157.0	314.0
TSE201800	1800	24	35	20	157.0	314.0
TSE202200	2200	24	35	20	157.0	314.0
TSE251000	1000	30	43	25	245.5	491.0
TSE251500	1500	30	43	25	245.5	491.0
TSE252260	2260	30	43	25	245.5	491.0
TSE321000	1000	42	45	32	401.9	803.9
TSE321400	1400	42	45	32	401.9	803.9
TSE322300	2300	42	45	32	401.9	803.9

Bespoke Couplers

Female Double Ended



Male Double Ended



Alligator Splice Off Couplers

The Alligator Couplers are used for splicing any grade or profile of reinforcing bar. These couplers are made for reinforcement steel with diameters in the range of 10mm to 40mm. Connection is made by inserting bars into both ends of the coupler. The breaking bolts are then screwed by hand and tightened by ratchet wrench until bolts shear off. These couplers can be used in particular cases to replace the damaged reinforcements with new ones and to connect to the old structure.

Advantages:

- No need for threading or any other bar preparation
- These are fast (simple) easy to use
- No special skilled labor required
- No welded components
- Performs as a continuous piece of rebar
- Allows for easy visually inspection

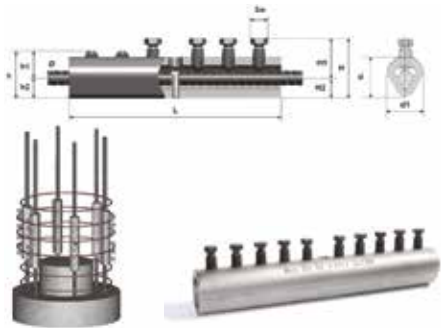

PRODUCT CODE	BAR DIA. (MM)	NO. OF BOLTS	BOLT THREAD	L (MM)	D (MM)	D1 (MM)	H (MM)	H1 (MM)	H2 (MM)	H (MM)	H1 (MM)	H2 (MM)	SW (MM)	TORQUE BOLTS (NM)
ALC10	10	6	M12	160	35	33	48	35	13	36	23	13	13	90 - 99
ALC12	12	6	M12	180	35	33	51	35	16	40	24	16	13	90 - 99
ALC14	14	8	M12	230	40	36	57	39	18	45	27	18	13	90 - 99
ALC16	16	8	M12	230	40	36	57	39	18	45	27	18	13	90 - 99

PRODUCT CODE	BAR DIA. (MM)	NO. OF BOLTS	BOLT THREAD	L (MM)	D (MM)	D1 (MM)	H (MM)	H1 (MM)	H2 (MM)	H (MM)	H1 (MM)	H2 (MM)	SW (MM)	TORQUE BOLTS (NM)
ALC18	18	10	M12	260	44	42	60	40	20	49	29	20	13	90 - 99
ALC20	20	10	M16	260	47	44	65	44	21	54	33	21	17	90 - 99
ALC22	22	10	M16	330	53	50	68	42	26	58	32	26	17	175 - 192
ALC25	25	12	M16	390	56	52	75	45	30	63	33	30	17	175 - 192
ALC28	28	12	M20	420	66	62	90	60	30	75	45	30	22	355 - 405
ALC32	32	14	M20	480	73	68	91	60	31	77	46	31	22	355 - 405
ALC36	36	16	M20	540	79	73	99	64	35	85	50	35	22	355 - 405
ALC40	40	18	M20	580	79	73	103	67	36	85	49	36	22	355 - 405

Alligator Coupler with Plate

The plate is designed to ensure dead end SW embedment for reinforcement steel bars in concrete. This helps to reduce the congestion and simplify the placement of reinforcement bars by removing the need for hooked ends.



PRODUCT CODE	BAR DIA. (MM)	NO. OF BOLTS	TORQUE BOLTS(NM)	SW (MM)	L (MM)
BCSOP10	10	3	90 - 99	13	88
BCSOP12	12	3	90 - 99	13	98
BCSOP14	14	4	90 - 99	13	123
BCSOP16	16	4	90 - 99	13	123
BCSOP20	20	5	90 - 99	13	150
BCSOP22	22	5	175 - 192	17	175
BCSOP25	25	6	175 - 192	17	205
BCSOP32	32	7	355 - 405	22	255
BCSOP36	36	8	355 - 405	22	285
BCSOP40	40	9	355 - 405	22	305

Dywidag Bar

A highly effective system of high tensile steel bar designed for holding formwork panels in place. The original, high quality Dywidag Threadbar may not be welded due to its chemical composition and must be protected against all kinds of weld spatter.



PRODUCT CODE	PRODUCT DESCRIPTION	STEEL GRADE	MAX. LOAD	WORKING LOAD (KN)	PRODUCT SIZE
FWK075	Dywidag Bar 15mm – 6 Metre Bar	15/17 mm	St 900/1100	195	6 Metre Lengths
FWK074	Dywidag Bar 20mm – 6 Metre Bar	20/23 mm	St 900/1100	345	6 Metre Lengths

Dywidag Wing Nuts

With different Waler Plates, Wing Nuts can be used as anchor nuts both for timber and steel walings, overcome by applying hammer strokes to the wings. They can be fixed and loosened using a hexagon wrench or threadbar. If necessary, a clamping effect can be attained or overcome by applying hammer strokes to the wings.



PRODUCT CODE	PRODUCT DESCRIPTION	HEIGHT	HEX	PRODUCT SIZE
FWK077	Dywidag Wing Nut 15mm	55 mm	27 mm	Each
FWK081	Dywidag Wing Nut 20mm	60 mm	36 mm	Each

Dywidag Slope Plate

Features a wing nut that is undetachable from the plate, both the plate and the nut are cast.



PRODUCT CODE	PRODUCT DESCRIPTION	PRODUCT SIZE
FWK078	Dywidag Slope Plate 15 mm	Each

Dywidag Hexagonal Weldable Nuts

Used as an alternative to the wing nut when access is restricted.



PRODUCT CODE	PRODUCT DESCRIPTION	HEX	PRODUCT SIZE
FWK089	Hexagonal Nuts (Weldable) 15mm x 50mm	36 mm	Each
FWK088	Hexagonal Nuts (Weldable) 20 mm x 70 mm	36 mm	Each

Dywidag Waler Plates

Waler Plates are used for timber or steel walings in conjunction with a winged nut or a hex nut for load transfer.



PRODUCT CODE	PRODUCT DESCRIPTION	HEX	PRODUCT SIZE
FWK082	Dywidag Waler Plate 15 mm x 105 mm	30 mm	Each / 25 Per Bag
FWK083	Dywidag Waler Plate 20 mm x 130 mm	36 mm	Each / 25 Per Bag

Dywidag Connectors

Couplers for the force-fit connection of two threadbars. A stop pin in the middle of the coupler ensures an equal screwing-in length of both bars.



PRODUCT CODE	PRODUCT DESCRIPTION	PRODUCT SIZE
FWK076	Dywidag Connector 15 mm	Each
FWK084	Dywidag Connector 20 mm	Each

End Cones

Plastic cones used for the support of shuttering pans at the end of tubing.



PRODUCT CODE	PRODUCT DESCRIPTION	PRODUCT SIZE
FWK005	Cones 22 mm x 10 mm	500 per Bag
FWK006	Cones 26 mm x 10 mm	500 per Bag
FWK011	Cones 22 mm x 50 mm	100 per Bag
FWK012	Cones 26 mm x 50 mm	100 per Bag

Tubing

Rough rigid tube used as a spacer between formwork that allows tie bar to be removed for re-use.



PRODUCT CODE	PRODUCT DESCRIPTION	PRODUCT SIZE
FWK003	Tubing 22 mm	100 metre Bundle
FWK004	Tubing 26 mm	50 metre Bundle

Expansion Shells

Expansion shells are used for fixing single-sided shuttering or similar structures in rock, concrete or comparable load-bearing ground. When installing expansion shells, please consult the separate installations instructions available on demand.



PRODUCT CODE	PRODUCT DESCRIPTION	PRODUCT SIZE
FWK086	Dywidag Expansion Shell 15 mm	Each

Threaded End Cones

Plastic cones used for support of shuttering pans at the end of tubing.



PRODUCT CODE	PRODUCT DESCRIPTION	PRODUCT SIZE
FWK014	22 mm x 30 mm Threaded End Cone	100 per Bag

Robusta Drop in Anchor

A drop-in anchor specifically designed for the use with 15mm formwork Tie Rod Bars. It is ideal for low load applications, such as fixings for handrails into existing concrete. For safety reasons we state that admissible loads for a low concrete strength of 15M/mm. This means in practice that the anchors are often installed the next day after concreting and are already loaded.



PRODUCT CODE	PRODUCT DESCRIPTION	PRODUCT SIZE
FWK085	Robusta Drop in Anchor	Each

Tie Bar Form Anchor

Tie Bar Form-Anchor is versatile, non-corrosive and used mainly for securing single-sided and climbing formwork. Easily fixed using the plastic cone locator enabling quick formwork erection, with no drilling of plywood. Can also be used for securing slab edge formwork, guard rails, etc. For use with 15mm Dywidag Tie Rods. Safe working load 50kn.



PRODUCT CODE	PRODUCT DESCRIPTION	PRODUCT SIZE
FWK087	Tie Bar Form Anchor 15 mm	Each / 100 Per Box

Groove Cap

Used instead of cones but not removed after pouring concrete. The ribs provide a good bond with the concrete and improve water impremeability.



PRODUCT CODE	PRODUCT DESCRIPTION	PRODUCT SIZE
FWK017	Groove Cap 26 mm x 20 mm	250 per Bag

Groove Plug

Used to close both ends of the Groove Caps, eliminating the need for rubber stoppers or Tiestop.



PRODUCT CODE	PRODUCT DESCRIPTION	PRODUCT SIZE
FWK018	Groove Plug 26 mm	500 per Bag

SST Formwork Plug

Plastic plug to close holes in formwork.



PRODUCT CODE	PRODUCT DESCRIPTION	PRODUCT SIZE
FWK015	SST Formwork Plug 20-25	500 per Bag

Double Wall Dowel

Double-wall dowel for attaching braces for precast concrete during construction. Made from high quality plastic. The double-wall dowel will be glued on the formwork. A screw with diameter 12x70mm is needed for fixation of the braces on the double-wall dowel.



PRODUCT CODE	PRODUCT DESCRIPTION	PRODUCT SIZE
FWK204	Double Wall Dowel	250 per Bag

Plastic Kicker Without Nail

Plastic kickers are used to locate the formwork panel at the base of walls. Supplied without nail. Fixed using masonry nails.



PRODUCT CODE	PRODUCT DESCRIPTION	PRODUCT SIZE
FWK009	Plastic Kicker	100 per Bag

Aqua Plug

Soft elastic PVC plug for sealing flexible tight fittings for internal sealing of plastic sleeves prior to filling with Tiestop.



PRODUCT CODE	PRODUCT DESCRIPTION	PRODUCT SIZE
FWK000	Aqua Plug Flexi 22 mm	500 per Bag
FWK002	Aqua Plug Flexi 26mm	500 per Bag

Tiestop Sealer

For filling holes formed by formwork bolts in new construction, particularly where a rapid setting, durable and waterproof mortar is required.



PRODUCT CODE	PRODUCT DESCRIPTION	PRODUCT SIZE
FWK350	Tiestop Sealer	8Kg

Plastic Shim

Allow for alignment and levelling of heavy section steel plate and pre-cast concrete sections.



PRODUCT CODE	PRODUCT DESCRIPTION	PRODUCT SIZE
PLA170	Plastic Shim 2 mm: 70 x70 mm	125 per Bag
PLA171	Plastic Shim 3 mm: 70 x 70 mm	125 per Bag
PLA172	Plastic Shim 5 mm: 70 x 70 mm	125 per Bag
PLA173	Plastic Shim 7 mm: 70 x 70 mm	125 per Bag
PLA174	Plastic Shim 9 mm: 70 x 70 mm	125 per Bag
PLA174B	Plastic Shim 20 mm: 70 x 70 mm	50 per Bag

Plastic Void Former

Void Formers used in or on ground concrete slabs to reduce the volume of concrete whilst maintaining the overall strength of the slab.



PRODUCT CODE	PRODUCT DESCRIPTION	PRODUCT SIZE
FWK120	Void Former 20 x 10 mm	Per 3 Metre
FWK121	Void Former 20 x 20 mm	Per 3 Metre

K-Form UPVC Screed Rail

K-Form plastic shuttering system made from uPVC is a light weight, durable and does not require removal after concrete pouring. It is easily cut to length on site and has pre-drilled holes in the vertical face for

locating steel dowel bars and in the base for mortar anchoring. Furthermore, K-Form’s patented design features a built-in expansion joint, end clips for jointing and a removable top strip for joint sealing.



PRODUCT CODE	PRODUCT DESCRIPTION	PRODUCT SIZE
KFM001	K-Form – K135 with 2 number Jointer. Designed for slab depth 150 mm-225 mm (when used in conjunction with K25 Riser).	3 Metre Lengths
KFM005	K-Form – K85 with 1 number Jointer. Designed for slab depth 100 mm-140 mm (when used in conjunction with K25 Riser).	3 Metre Lengths
KFM008	K-Form – K35 with 1 number Jointer. Designed for slab depth 50 mm-100 mm.	3 Metre Lengths
KFM010	K-Form – Risers 25mm	3 Metre Lengths
KFM015	K-Form – Crosses	Each
FWK185	Dowel Bar Cap 40mm	100 per box

Dowel Bars

Mild steel plain round bars with sawn end. Bar cutting available on request.
Finished in stainless steel.
(Galvanised or polymeric available on request.)



PRODUCT CODE	PRODUCT DESCRIPTION	PRODUCT SIZE
FWK068	Dowel Bar R12 x 900 mm	Each
FWK071	Dowel Bar R16 x 600 mm	Each
FWK072	Dowel Bar R20 X 600 mm	Each
FWK069	Dowel Bar R25 x 600 mm	Each

Dowel Bar Caps

Dowel bar caps have a compressible filler which allows for the expansion of dowel bars.



PRODUCT CODE	PRODUCT DESCRIPTION	PRODUCT SIZE
FWK180	Dowel Bar Cap 12 mm	100 per box
FWK181	Dowel Bar Cap 16 mm	100 per box
FWK182	Dowel Bar Cap 20 mm	100 per box
FWK183	Dowel Bar Cap 25 mm	100 per box
FWK184	Dowel Bar Cap 32 mm	100 per box
FWK185	Dowel Bar Cap 40 mm	100 per box

Dowel Bar Sleeves

PVC dowel bar sleeves acts as a method of debonding of the mild steel dowel bars.



PRODUCT CODE	PRODUCT DESCRIPTION	PRODUCT SIZE
FWK190	Dowel Bar Sleeve 12 mm x 450 mm	100 per box
FWK191	Dowel Bar Sleeve 16 mm x 300 mm	100 per box
FWK192	Dowel Bar Sleeve 20 mm x 300 mm	100 per box
FWK193	Dowel Bar Sleeve 25 mm x 300 mm	100 per box
FWK194	Dowel Bar Sleeve 32 mm x 375 mm	50 per box

Protection Board

Protection Board is used for the protection of floors, walls, windows, stairs and doors in the construction industry and especially during refurbs – it is lightweight and cost effective.

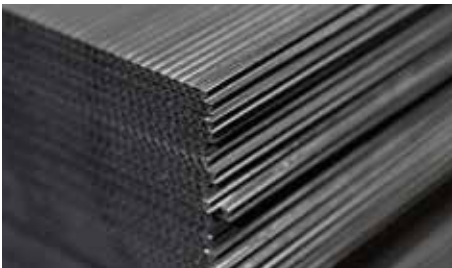

PRODUCT CODE	PRODUCT DESCRIPTION	PRODUCT SIZE
PER010	Protection Board 1220 x 2440 x 2 mm Black	1220 x 2440 mm Sheet

Chamfer with Flange

Forming chamfered edges to columns and beams – the flanged profile allows for nailing to the formwork.



PRODUCT CODE	PRODUCT DESCRIPTION	PRODUCT SIZE
FWK167	10 mm Chamfer with Flange	100 metres per bundle
FWK160	11 mm Chamfer with Flange	100 metres per bundle
FWK161	15 mm Chamfer with Flange	100 metres per bundle
FWK162	20 mm Chamfer with Flange	100 metres per bundle
FWK163	25 mm Chamfer with Flange	50 metres per bundle

Chamfer without Flange

Forming chamfered edges to columns and beams.



PRODUCT CODE	PRODUCT DESCRIPTION	PRODUCT SIZE
FWK164	Chamfer 15 mm no Flange	100 metres per bundle
FWK165	Chamfer 20 mm no Flange	100 metres per bundle
FWK165	Chamfer 25 mm no Flange	100 metres per bundle

Bolt Boxes

Used to position holding down bolts in concrete bases. Available in light duty, heavy duty and cardboard.



PRODUCT CODE	PRODUCT DESCRIPTION	PRODUCT SIZE
FWK025	Bolt Box 225 mm – 24 mm Bolt	Each / 100 per bale
FWK026	Bolt Box 300 mm – 24 mm Bolt	Each / 100 per bale
FWK027	Bolt Box 375 mm – 24 mm Bolt	Each / 100 per bale
FWK028	Bolt Box 450 mm – 24 mm Bolt	Each / 100 per bale
FWK029	Bolt Box 600 mm – 24 mm Bolt	Each / 100 per bale
FWK035	Bolt Box Waxed Cardboard 229 mm	Each/ 400 per box
FWK036	Bolt Box Waxed Cardboard 305 mm	Each / 300 per box
FWK037	Bolt Box Waxed Cardboard 380 mm	Each / 200 per box
FWK038	Bolt Box Waxed Cardboard 457 mm	Each / 100 per box
FWK039	Bolt Box Waxed Cardboard 534 mm	Each / 100 per Box

Bottom Crack Inducer

Used where a vertical crack formed from the base of the slab is required.



PRODUCT CODE	PRODUCT DESCRIPTION	PRODUCT SIZE
FWK170	Bottom Crack Inducer 40 MM	5 Metres

Top Crack Inducer

Used in external concrete slab areas where the joint must be sealed – the top part is removed after the concrete has set to facilitate sealing.



PRODUCT CODE	PRODUCT DESCRIPTION	PRODUCT SIZE
FWK171	Top Crack Inducer 50 MM	5 Metres

Hy-Rib

Expanded metal sheet product, designed to use as permanent formwork. Creates a mechanical key for the second phase pour.



PRODUCT CODE	PRODUCT DESCRIPTION	PRODUCT SIZE
FWK090	Hy-Rib 0.445 x 2 M	0.445 x 2 Metres Per Sheet

Polythene

Manufactured from high quality recycled polyethylene for use in solid concrete ground floors to protect buildings against water from the ground providing an effective barrier against liquid or water vapour for the lifetime of the concrete slab in which they are installed.



PRODUCT CODE	PRODUCT DESCRIPTION	PRODUCT SIZE
FWK149	Polythene TPS Clear 50 mu/200 g	Per Roll: 4 x 25 Metres
FWK151	Polythene DPM 300 mu/1200 g (BBA)	Per Roll: 4 x 25 Metres
FWK152	Polythene DPM 250 mu/1000 g (BBA)	Per Roll: 4 x 25 Metres

Formwork Foam

Grout check tape, adhesive foam strip designed for inaccessible joints to prevent grout loss.



PRODUCT CODE	PRODUCT DESCRIPTION	PRODUCT SIZE
NUF049	Formwork Foam 12 x 6mm	10 Metre Roll
NUF049B	Formwork Foam 24 x 12 mm	5 Metre Roll

Jointstrip

Jointstrip is a closed cell cross linked polyethylene foam which provides a fast, efficient and cost-effective system for all brick and concrete expansion joints. It has proven to be excellent for isolating structural components and forming joints in concrete slabs.



PRODUCT CODE	PRODUCT DESCRIPTION	PRODUCT SIZE
JNT002	Jointstrip 125 x 10mm	10 Metre Roll / 120 Metre Bundle
JNT010	Jointstrip 100 x 10mm	10 Metre Roll / 120 Metre Bundle
JNT011	Jointstrip 150 x 10mm	10 Metre Roll / 80 Metre Bundle
JNT012	Jointstrip 175 x 10mm	10 Metre Roll / 60 Metre Bundle
JNT013	Jointstrip 200 x 10mm	10 Metre Roll / 60 Metre Bundle
JNT014	Jointstrip 250 x 10mm	10 Metre Rolls / 40 Metre Bundle
JNT015	Jointstrip 300 x 10mm	10 Metre Rolls / 30 Metre Bundle
JNT020	Jointstrip 100 x 20mm	2 Metre Lengths / 50 Metre Bale
JNT021	Jointstrip 150 x 20mm	2 Metre Lengths / 50 Metre Bale
JNT022	Jointstrip 175 x 20mm	2 Metre Lengths / 50 Metre Bale
JNT023	Jointstrip 200 x 20mm	2 Metre Lengths / 50 Metre Bale
JNT025	Jointstrip 250 x 20mm	2 Metre Lengths / 50 Metre Bale
JNT026	Jointstrip 300 x 20mm	2 Metre Lengths / 50 Metre Bale

Other sizes available on request.

Jointstrip Expancell Sheets

Expancell is a closed cell polyethylene foam. It offers an easy and efficient method of forming expansion voids in brickwork, blockwork and concrete.



PRODUCT CODE	PRODUCT DESCRIPTION	PRODUCT SIZE
JNT070	Expancell Sheet 12 mm 2M x 1.2M	2 x 1.2 Metre – 100 Per Pallet
JNT071	Expancell Sheet 15 mm 2M x 1.2M	2 x 1.2 Metre – 100 Per Pallet
JNT072	Expancell Sheet 20 mm 2M x 1.2M	2 x 1.2 Metre – 100 Per Pallet
JNT073	Expancell Sheet 25 mm 2M x 1.2M	2 x 1.2 Metre – 64 Per Pallet

Expansion Cord

Closed cell polyethylene foam cord in varying diameters. Used behind sealants and mastics in expansion.



PRODUCT CODE	PRODUCT DESCRIPTION	PRODUCT SIZE
JNT028	Expanded Cord 10 mm	1 Metre / 1150 Metre per box
JNT030	Expanded Cord 13 mm	1 Metre / 750 Metre per box
JNT031	Expanded Cord 15 mm	1 Metre / 550 Metre per box
JNT032	Expanded Cord 20 mm	1 Metre / 350 Metre per box
JNT033	Expanded Cord 25 mm	1 Metre / 200 Metre per box
JNT036	Expanded Cord 30 mm	1 Metre / 160 Metre per box
JNT034	Expanded Cord 40 mm	2 Metres / 270 Metre per box
JNT035	Expanded Cord 50 mm	2 Metres / 180 Metre per box

Fibre Fillerboard

Bitumen impregnated fibre fillerboard. It has excellent resistance to compression with outstanding recovery characteristics.



PRODUCT CODE	PRODUCT DESCRIPTION	PRODUCT SIZE
JNT088	Fibre Fillerboard 1220 x 2200 x 12 mm	1.22 x 2.2 Metre
JNT089	Fibre Fillerboard 1220 x 2200 x 19 mm	1.22 x 2.2 Metre
JNT090	Fibre Fillerboard 1220 x 2200 x 25 mm	1.22 x 2.2 Metre

EXPANSION JOINT MATERIALS

Texslip Membrane

Slip membranes are produced from an ultra-heavy 250kg/m³ density polyethylene, 2mm in thickness, it is used in sliding joints where low friction resistance material is needed, but a high resistance to load is also required. Normally used in two layers to form a low friction load bearing sliding joint.

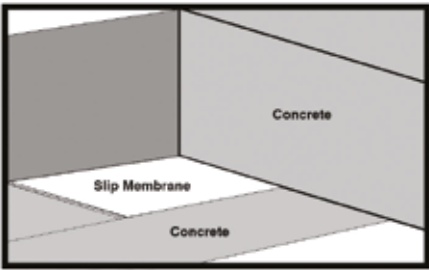

PRODUCT CODE	PRODUCT DESCRIPTION	PRODUCT SIZE
FWK220	Texslip Membrane 2 mm – 1.2 x 100 Metre	Per roll

Foam Frost Mats

Frost Mats – Perfect for winter concrete laying and curing. When the temperature drops, concrete pours and curing can be difficult – an easy and inexpensive solution is the use of thermally insulated frost mats. The thermal insulation effect keeps the concrete warm long enough for a safe curing and reduces the loss of hydration. The frost mats are lightweight, reusable and recyclable.



PRODUCT CODE	PRODUCT DESCRIPTION	PRODUCT SIZE
FWK155	Foam Frost Blankets 75 x 1.5 Metre x 7 mm Thick	Each

PERMANENT FORMWORK

Perm-E-Form

Perm-E-Form is a fast and simple system for construction of in-situ concrete ground beams and pile caps. Developed to save money, time and labour, Perm-E-Form is proving popular with many contractors. Perm-E-Form Beam Forming System is designed to meet the individual size requirements of

concrete ground beam forming in light commercial and house building developments. An ideal product where ground beams are constructed in-situ onto piling or in unstable and contaminated ground situations.

Other sizes available on request.

PRODUCT CODE	PRODUCT DESCRIPTION	PRODUCT SIZE
PER0030	Perm-E-Form 100 mm	2 Metre Strip
PER001	Perm-E-Form 500 mm	2 Metre Strip
PER002	Perm-E-Form 625 mm	2 Metre Strip
PER003	Perm-E-Form 833 mm	2 Metre Strip
PER007	Perm e Form 1000 mm	2 Metre Strip
PER005	Perm-E-Form 1250 mm	2 Metre Strip
PER015B	Perm-E-Form 2500 wide x 2000 mm long Full Sheet	Per Sheet
PER050	White Perm e Form 2.5m x 2.5m	2.5 Metre Sheet



SAFETY SYSTEMS

Safety Caps

The protection cap is screwed onto the reinforcing bar and fits tightly and securely due to the ribbed construction on all reinforcement diameters. This is not possible with conventional caps.

The cap can be used several times and increases the visibility of danger points by the high visible colour, yellow.



PRODUCT CODE	PRODUCT DESCRIPTION	PRODUCT SIZE
FWK200	Safety Caps 6-18 mm	250 Per Bag
FWK201	Safety Caps 16-32 mm	250 Per Bag
FWK202	Safety Caps 25-40 mm	100 Per Bag

Nevosafe®

The Nevosafe® safety strip can be easily and quickly installed due to the integrated handle strip. It can be applied in horizontal and vertical positions and can be re-used. The Nevosafe® is available in high visible colours to increase visibility.

Range includes:

- Nevosafe®
- Nevosafe® with Steel Core



Nevosafe® TS

For application during storage and transport of precast concrete elements. Safety strip for securing cantilevered reinforcing bars.



CONCRETE DECK & WALL SPACERS

LINE SPACERS

Wire Spacers

Provides support for mesh in ground floor slabs.
Available in 2 Metre lengths and in heights up to 300 mm.

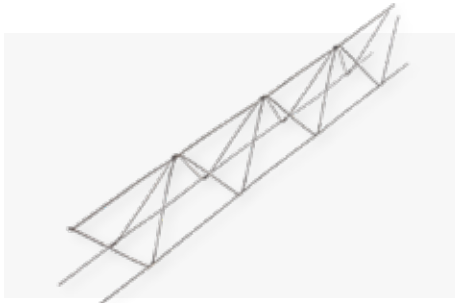

PRODUCT CODE	PRODUCT DESCRIPTION	PRODUCT SIZE
WIR013	50 mm WIRE SPACER	50 Meters
WIR014	75 mm WIRE SPACER	50 Meters
WIR015	90 mm WIRE SPACER	50 Meters
WIR016	105 mm WIRE SPACER	50 Meters
WIR017	120 mm WIRE SPACER	50 Meters
WIR017B	135 mm WIRE SPACER	50 Meters
WIR018	150 mm WIRE SPACER	50 Meters
WIR018B	165 mm WIRE SPACER	50 Meters
WIR019	180 mm WIRE SPACER	50 Meters
WIR019B	200 mm WIRE SPACER	50 Meters
WIR024	250 mm WIRE SPACER	20 Meters
WIR025	300 mm WIRE SPACER	20 Meters

Other sizes available on request.

Trik Trak

Spacer for light easy continuous stable support for mesh and reinforcement. Large lateral cut-outs allow for free flow of concrete. 2 Metre lengths. Available in cover mm.



PRODUCT CODE	PRODUCT DESCRIPTION	PRODUCT SIZE
CLS008	Trik Trak 20 mm	100 per Bundle
CLS001	Trik Trak 25 mm	100 per Bundle
CLS002	Trik Trak 30 mm	100 per Bundle
CLS003	Trik Trak 35 mm	60 per Bundle
CLS004	Trik Trak 40 mm	60 per Bundle
CLS005	Trik Trak 50 mm	60 per Bundle
CLS007	Trik Trak 60 mm	40 per Bundle

Zig Zag Trik Trak

Stable spacer for lower reinforcement, with the following advantages:

- Does not break if stood on
- Cannot overturn
- High load bearing capacity
- No cavitation due to optimum inclusion in concrete
- Avoids the formation of linear cracks in concrete
- 2 Metre lengths.



PRODUCT CODE	PRODUCT DESCRIPTION	PRODUCT SIZE
CLS010	Zig Zag Trik Trak 25mm	100 Metres per Bundle
CLS011	Zig Zak Trik Trak 30mm	100 Metres per Bundle
CLS012	Zig Zag Trik Trak 35mm	80 Metres per Bundle
CLS013	Zig Zag Trik Trak 40mm	80 Metres per Bundle
CLS014	Zig Zag Trik Trak 50mm	80 Metres per Bundle

Centipede Spacer

Rod type spacer which offers minimal contact with the concrete face, primarily for use in precast factories. Available in 2 Metre lengths.



PRODUCT CODE	PRODUCT DESCRIPTION	PRODUCT SIZE
CLS049	Centipede Spacer 15 mm	64 Metres per Bundle
CLS048	Centipede Spacer 20 mm	64 Metres per Bundle
CLS050	Centipede Spacer 25 mm	64 Metres per Bundle
CLS051	Centipede Spacer 30 mm	80 Metres per Bundle
CLS052	Centipede Spacer 40 mm	24m Metres per Bundle
CLS053	Centipede Spacer 35 mm	24m Metres per Bundle

Centipede Spacer with Uprights

Rod type spacer which offers minimal contact with the concrete face. The uprights prevent movement of the rebar, primarily for use in precast factories. Available in 2 Metre lengths.



PRODUCT CODE	PRODUCT DESCRIPTION	PRODUCT SIZE
CLS060	Centipede Spacer 25 mm with Uprights	200 per Bundle
CLS058	15mm Centipede Spacer with Uprights	200 per Bundle
CLS059	20mm Centipede Spacer with Uprights	200 per Bundle
CLS060	25mm Centipede Spacer with Uprights	200 per Bundle
CLS061	30mm Centipede Spacer with Uprights	200 per Bundle
CLS062	40mm Centipede Spacer with Uprights	200 per Bundle
CLS063	50mm Centipede Spacer with Uprights	200 per Bundle

Wheel Spacers

For fixing spacing of vertical reinforcements – available to suit various bar diameter and cover.



PRODUCT CODE	PRODUCT DESCRIPTION (COVER/BAR DIA MM)	PRODUCT SIZE
WSP002	Wheel Spacer 15 mm 4-10	1000 Small /5000 Large
WSP010	Wheel Spacer 20 mm 4-12	1000 Small /4000 Large
WSP011	Wheel Spacer 25 mm 4-12 S	500 Small /2500 Large
WSP012	Wheel Spacer 30 mm 4-12 S	250 Small /1500 Large
WSP013	Wheel Spacer 35 mm 4-12	200 Small /1000 Large
WSP014	Wheel Spacer 40 mm 5-14	125 Small /750 Large
WSP015	Wheel Spacer 50 mm 8-14	100 Small /500 Large
WSP020	Wheel Spacer 30 mm 6-20	125 Small /1000 Large
WSP021	Wheel Spacer 35 mm 6-20	125 Small /1000 Large
WSP030	Wheel Spacer 20 mm 6-20	250 Small /2000 Large
WSP031	Wheel Spacer 25 mm 6-20	250 Small /1000 Large
WSP032	Wheel Spacer 40 mm 6-20	125 Small /500 Large
WSP033	Wheel Spacer 50 mm 12/20	250 Small
WSP035	Wheel Spacer 60 mm 12-20	250 Small

A Spacer

A strong economical general-purpose spacer that can be used in vertical or horizontal applications – suits bars ranging from 4-20mm.



PRODUCT CODE	PRODUCT DESCRIPTION (COVER/BAR DIA MM)	PRODUCT SIZE
PLA003	Spacer A20	2000 Bag
PLA005	Spacer A25 MDPE	1000 Bag
PLA006	Spacer A30 MDPE	1000 Bag
PLA007	Spacer A35 MDPE	1000 Bag
PLA008	Spacer A40 MDPE	1000 Bag
PLA009	Spacer A50 MDPE	1000 Bag
PLA010	Spacer A60 HD	1000 Bag

ASKP Spacers

Plastic support spacers for vertical reinforcement with point-shaped formwork support and moulded terminals to hook into reinforcement mats (clamping distance: 150mm).

Cover/bar diameter (mm) available in:



PRODUCT CODE	PRODUCT DESCRIPTION	PRODUCT SIZE
PLA200	ASKP Spacer 20 mm	1000 per Bag
PLA202	ASKP Spacer 25 mm	1000 per Bag
PLA201	ASKP Spacer 30 mm	1000 per Bag

Tower Spacer

Stable spacer with pointed legs to ensure minimum visibility on the concrete surface.

Cover/bar diameter (mm) available:



PRODUCT CODE	PRODUCT DESCRIPTION	PRODUCT SIZE
PLA210	Tower Spacer 20/6-20	1000 per Box
PLA211	Tower Spacer 25/6-20	1000 per Box
PLA215	Tower Spacer 40/6-20	1000 per Box
PLA217	Tower Spacer 60/6-20	1000 per Box

Flat Foot Spacer

Provides stable support to reinforcing steel in ground floor slabs and its large base area prevents puncturing of polythene film. The clip feature also allows for vertical application.

Cover/bar diameter (mm) available in:



PRODUCT CODE	PRODUCT DESCRIPTION	PRODUCT SIZE
PLA072	Flat Foot Spacer 25/30	250 per Bag
PLA073	Flat Foot Spacer 40/50	200 per Bag
PLA074	Flat Foot Spacer 65/75	200 per Bag

Pile Cage Spacer

Specially designed for use with pile cages. Clip on design allows for simple fixing to helical or main bars.



PRODUCT CODE	PRODUCT DESCRIPTION	PRODUCT SIZE
PLA198	Pile Cage Spacers 75 mm	1000 per Box

Paving Support Spacer

Stackable fixed height supports are ideal for paving on straightforward projects. They act as a guide when laying paving, ensuring uniform position.



PRODUCT CODE	PRODUCT DESCRIPTION	PRODUCT SIZE
PLA106	Paving Support Static 15 mm	175 per Box

Adjustable Paving Supports

Adjustable Plastic Paving Support Pads are designed to be rotated at the head so that the height can be very finely adjusted, to take into account small, continuous and irregular differences in the levels of a particular area.



PRODUCT CODE	PRODUCT DESCRIPTION	PRODUCT SIZE
PLA011	Adj Paving Supports 35-50 mm	25 per Box
PLA012	Adj Paving Supports 50-70 mm	25 per Box
PLA013	Adj Paving Supports 65-100 mm	25 per Box
PLA014	Adj Paving Supports 95 – 130 mm	25 per Box
PLA015	Adj Paving Supports 125-160 mm	25 per Box
PLA016	Adj Paving Supports 155-190 mm	25 per Box
PLA017	Adj Paving Supports 185-220 mm	25 per Box

CONCRETE

Fibre Concrete Bar

Ensures concrete cover for high requirements.

Getting the right amount of concrete cover is essential for the durability of reinforced concrete structures. Fibre concrete spacers ensure correct concrete cover before and during concreting. They are characterized by high compressive strength and excellent chemical and physical resistance.

Advantages:

- Cement-bound spacers, no heat/cold deformation
- Absolute guarantee of concrete cover
- Various attachment options for quick and easy use
- Precise positioning
- Homogeneous bond, no hairline cracks between spacer and concrete
- Fire-resistant according to the maximum requirements of DIN 4102 - Class A1 (non-flammable)



PRODUCT CODE	PRODUCT DESCRIPTION	PRODUCT SIZE
CON001	25 mm Concrete Bar	600 Metres per Pallet
CON002	30 mm Concrete Bar	600 Metres per Pallet
CON110	40 mm Concrete Bar	440 Units per Pallet
CON111	50 mm Concrete Bar	330 Units per Pallet
CON112	60 mm Concrete Bar	234 Units per Pallet
CON113	75 mm Concrete Bar	150 Units per Pallet
CON114	100 mm Concrete Bar	70 Units per Pallet

Fibre Concrete Spacers

Wide range of heavy-duty spacers for accurate placing of both horizontal and vertical reinforcement and mesh maximum stability under normal loading conditions.



PRODUCT CODE	PRODUCT DESCRIPTION	PRODUCT SIZE
CON071	Concrete Spacer 35/40/50	200 per Bag
CON054	Concrete Spacer 50/60 Arch Base	125 per Bag
CON072	Concrete Spacer 40/50 Arch Base	200 per Bag
CON057	Concrete Spacer 65/75 Arch Base	50 per Bag
CON055	Concrete Spacer 60/75 Flat Base	50 per Bag
CON150	25 mm Concrete Spacer with Plastic Slip	480 per Bag
CON151	35 mm Concrete Spacer with Plastic Clip	340 per Bag
CON152	50 mm Concrete Spacer with Plastic Clip	215 per Bag
CON160	35/40/50 Pre-Wired 50N Concrete Spacers	185 per Bag

ACCESSORIES

Black Annealed Tying Wire

Tying wire is used for connecting loose rebar on-site to prevent any movement of the reinforcement during pouring and curing. Soft and malleable and can be bent, twisted and tied.



PRODUCT CODE	PRODUCT DESCRIPTION	PRODUCT SIZE
WIR050	Black Annealed Tying Wire	12 Kg Coils

Stainless Steel Tying Wire

Stainless Steel Tying Wire is used where there is a risk of staining.



PRODUCT CODE	PRODUCT DESCRIPTION	PRODUCT SIZE
WIR051	Stainless Steel Tying Wire 18 Gauge – 1.2 mm Diameter	15 Kg

Steel Fixers Nips

Precision cutting for soft and hard wire.



PRODUCT CODE	PRODUCT DESCRIPTION	PRODUCT SIZE
TLS001	Wire Cutters	Each

Wire Ties

Alternative to tying wire, pre-formed looped wire ties. Wrap around reinforcing bar and pull through using wire tying tool.



PRODUCT CODE	PRODUCT DESCRIPTION	PRODUCT SIZE
WIR034	S/S Wire Ties 6 Inch	1000 Small /5000 Large
WIR035	Wire Ties 6 Inch	1000 Small /5000 Large
WIR036	Wire Ties 8 Inch	1000 Small /5000 Large

Tying Tool

Tool for use with the Wire Ties.



PRODUCT CODE	PRODUCT DESCRIPTION	PRODUCT SIZE
WIR037	Wire Tying Tool	Each

Wire Binders

Used with wire ties, twists and tightens. Rubber hand grip for a firm hold.

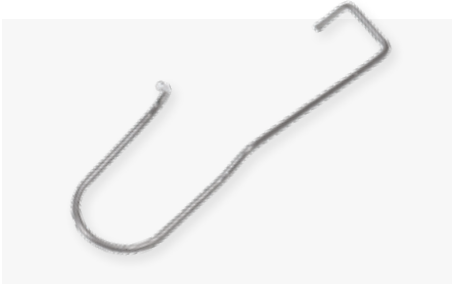

PRODUCT CODE	PRODUCT DESCRIPTION	PRODUCT SIZE
WIR020	Wire Binder 8/12	9600/Box
WIR021	Wire Binder 8/16	8000/Box
WIR022	Wire Binder 8/20	5600/Box

CONSTRUCTION GROUTS, MORTARS AND RELEASE AGENTS

RELEASE AGENTS

Omnilease Bio

Vegetable Oil Based

Vegetable oil-based release agent which forms a thin, colourless film on the surface of formwork. It facilitates the even dispersion of the concrete and assists bubble resorption during vibration. It is non-toxic, environmentally & user friendly and produces quality pre-cast finishes.



PRODUCT CODE	PRODUCT DESCRIPTION	PRODUCT SIZE
OMN053	Omnilease Bio 25 Litres	25 Litres
OMN054	Omnilease Bio 210 Litres	210 Litres
OMN055	Omnilease Bio 1000 Litres	1000 Litres

Logco-Lease

Chemical Based

Versatile high specification chemical release agent blended with highly active surfactants ensures that optimum release is attained hence achieving a high-quality concrete surface finish. Produces uniform, stain-free concrete – can be used on timber, plywood, metal and plastic formwork.



PRODUCT CODE	PRODUCT DESCRIPTION	PRODUCT SIZE
OMN001	Logcolease 20 Litres	20 Litres
OMN002	Logcolease 205 Litres	205 Litres
OMN003	Logcolease 1000 Litres	1000 Litres

CURING AGENTS

Water Based

An environmentally friendly concrete curing membrane. A blue grade version is also available to help in identification during application.

- Concrete Hardener
- Dustproofers
- Curing Agent



PRODUCT CODE	PRODUCT DESCRIPTION	PRODUCT SIZE
NUF006A	ECO Cure ww	20 Litres
NUF005C	ECO Cure ww	205 Litres
NUF006C	ECO Cure ww	1000 Litres

Solvent Based R90

High efficiency curing membrane for concrete, cures to a minimum of 90% efficiency. Protects the concrete surface from rapid water evaporation during the initial curing stages. R90 has a water retention efficiency in excess of 90%.



PRODUCT CODE	PRODUCT DESCRIPTION	PRODUCT SIZE
NUF009C	Logco R90	25 Litres
NUF009A	Logco R90	205 Litres

Solvent Based R90 Aluminised

Aluminised high efficiency curing membrane for concrete, cures to a minimum of 90% efficiency.

Added aluminium flakes where requirement for light reflection it is required to keep the temperature of the concrete to a minimum or a pigment is required. Offers 90% water retention.



PRODUCT CODE	PRODUCT DESCRIPTION	PRODUCT SIZE
NUF008A	Logco R90A	205 Litres

Acrylic Based Concrete Curing & Sealing Compound for Floors

High Performance heavy duty acrylic sealer. Hardseal is a low viscosity, penetrating colourless sealer and is based on a carefully sourced blend of chemicals. It hardens, seals and cures all in one. Also offers 90% curing efficiency.



PRODUCT CODE	PRODUCT DESCRIPTION	PRODUCT SIZE
NUF023A	Hardseal XS	20 Litres
NUF024A	Hardseal XS	205 Litres

Cleaning Agent

A powerful solvent cleaner used to clean all tools and equipment which have been in contact with resin-based materials.



PRODUCT CODE	PRODUCT DESCRIPTION	PRODUCT SIZE
NUF054	Nuwash	5 Litres

Debonding Agent

Designed for coating dowel bars in concrete roads, airfield joints and floor sections and is based on bitumen having a penetration between 100 and 200, blended with hydrocarbon solvents. The consistency of the material is such that once it has dried and the concrete cast, free movement between the bar and the surrounding concrete is achieved.



PRODUCT CODE	PRODUCT DESCRIPTION	PRODUCT SIZE
NUF026	Debonding Agent	5 Litres
NUF025	Debonding Agent	20 Litres

FORMWORK TREATMENT

Nulease Varnish Standard

Formwork varnish for sealing and protecting general formwork where the criterion is for multiple use.



PRODUCT CODE	PRODUCT DESCRIPTION	PRODUCT SIZE
NUF051	Nulease Varnish Standard	5 Litres

RETARDERS

Formwork Retarder - Paint On

Eco-Tard Liquid MF is an aqueous biodegradable pigmented retarder designed to be applied to formwork surfaces to produce an exposed aggregate surface which gives an excellent key for subsequent concreting or provides an alternative exposed finish. It is ideal for construction joints and rendering applications.



PRODUCT CODE	PRODUCT DESCRIPTION	PRODUCT SIZE
NUF003A	ECO Tard Liquid MF - (Paint on)	25 Litres

TopFace Retarder - Spray On

Topface retarder, water-based spray-applied retarder designed to expose aggregate on horizontal surfaces, biodegradable/environmentally friendly.



PRODUCT CODE	PRODUCT DESCRIPTION	PRODUCT SIZE
NUF001A	ECO Tard Liquid TF - (Spray on)	25 Litres

CEMENTITIOUS & RESIN STRUCTURAL GROUTS

Nugrout Hi Spec

A high strength, non-shrink, free flowing, cementitious grout based on low alkaline Portland cement and non-reactive aggregates. Meets the requirements of HA Specification clause 2601.4. Tested by Aston Material Services.



PRODUCT CODE	PRODUCT DESCRIPTION	PRODUCT SIZE
NUF071	Nugrout Hi Spec	25 Kg

Nugrout Flowable Concrete

Flowable, self-compacting mirco concrete containing nonreactive aggregates and which has a low Na2O content. Suitable for use where cathodic protection is in operation. Compiles with the requirements of HA Specification BD27/86 Clause 4. Tested by Scientifics Group.



PRODUCT CODE	PRODUCT DESCRIPTION	PRODUCT SIZE
NUF033	Nugrout Flowable Concrete	25 Kg

Epicon Grouts

EPICON GROUT L – Epoxy Grout: a three component pourable free flowing high strength grout for gaps over 20mm.

EPICON GROUT M – Epoxy Grout: A lightly filled pourable grout for free flow gap grouting, recommended for gaps between 5mm – 30mm.



EPICON GROUT S is based on solvent free epoxy resins. It is one of three epoxy grouts in our range which are specified below. These cover the majority of grouting and fixing applications encountered within civil engineering and the construction industry in general, where the mechanical properties must be of the highest order. Tropical versions of the epoxy grout range are available for large pours and warmer climates. Epicon Grout S is designed to comply with the requirements of EN1504 Part 5, due to its crack injecting / gap filling applications.

PRODUCT CODE	PRODUCT DESCRIPTION	PRODUCT SIZE
NUF031	Epicon Grout L	20 Kg
NUF029	Epicon Grout M	20 Kg
NUF028	Epicon Grout S	20 Kg

General Purpose Grout

Grout which is a blend of low alkali high specific surface Portland cements and other cementitious binders combined with high purity aggregates and a system of compatible admixtures. It is a high fluidity grout that will neither bleed or shrink.



PRODUCT CODE	PRODUCT DESCRIPTION	PRODUCT SIZE
TMC002	Hi-Flow GA Grout	20 Kg

Crack Injections Resins

A low viscosity epoxy injection resin for injection into concrete, masonry and brickwork to consolidate the structure and prevent ingress of moisture.

Also available as a Thixotropic epoxy injection resin designed to flow freely while under pressure.

Can be supplied as a prepacked kit containing Epicon injection resin and all ancillary equipment to enable small scale crack injection to be carried out by experienced operatives in either low viscosity or Thixotropic versions.



PRODUCT CODE	PRODUCT DESCRIPTION	PRODUCT SIZE
NUF030	Epicon Injection Resin Kit	Each
NUF055	Epicon Injection Resin LV 0.5 Kg	0.5 Kg
NUF057	Epicon Injection Resin LV 1 Kg	1 Kg

CEMENTITIOUS REPAIRS & PAVING PRODUCTS

Deck Repair Rapid

Polymer modified cement repair mortar characterised by its high early strength development and rapid moisture loss. The material has been designed to comply with the requirements of the Ha standard BD27/86 clause 6 and is an ideal material for the repair of bridge decks prior to waterproofing.



PRODUCT CODE	PRODUCT DESCRIPTION	PRODUCT SIZE
NUF027	Deck Repair Rapid	25 Kg

Nucem HB Mortar

High Build Lightweight Repair Mortar

High build lightweight fibre reinforced mortar designed for the repair and restoration of spalled or damaged concrete in the inverted and vertical plane. A prepacked material containing an SBR or acrylic gauging liquid to improve bonding and waterproofing properties of the mortar. Complies with the requirement of Ha 27.5 Kg standard BD 27/86 clause 6.



PRODUCT CODE	PRODUCT DESCRIPTION	PRODUCT SIZE
NUF041	Nucem HB Mortar	20 Kg

Nucem Mortar

Horizontal Repair Mortar

Prepacked cementitious mortar for the repair of sections between 10mm – 30mm mainly in the horizontal plane. Available with either an SBR or acrylic gauging liquid as required, guaranteed low W/c ratio. Complies with the requirements of Ha specification BD27/86 clause 6.



PRODUCT CODE	PRODUCT DESCRIPTION	PRODUCT SIZE
NUF070	Nucem Mortar	25 Kg

Nucem Primer

Repair Mortar

Water dispersed cementitious/epoxy primer tack coat for use with Acropak HB40 Mortar, Nucem HB Mortar, Nucem Mortar and Nucem Concrete. Also recommended for use when bonding fresh concrete to existing concrete.



PRODUCT CODE	PRODUCT DESCRIPTION	PRODUCT SIZE
NUF042	Nucem Primer	1 Kg

Nucem Skimcoat

Fairing Coat

Polymer modified cementitious levelling 12.5Kg 6.24 l coat with built-in flexibility and waterproofing properties at 1mm ideal for the treatment of repaired concrete and the surrounding areas to give an overall uniform appearance.



PRODUCT CODE	PRODUCT DESCRIPTION	PRODUCT SIZE
NUF043	Nucem Skim Coat	12.5 Kg

Nupatch Cosmetic Special

An easy to use cementitious compound which develops a high strength at an early age for small cosmetic repairs of both insitu and precast concrete. It can be colour-blended on site to match substrate.



PRODUCT CODE	PRODUCT DESCRIPTION	PRODUCT SIZE
NUF019	Cosmetic White	7.5 Kg
NUF020	Cosmetic Special	25 Kg
NUF021	Cosmetic Special	7.5 Kg

RESIN MORTARS & ADHESIVES

Epoxy FS Mortar

A rapid curing epoxy mortar. Allows concrete 5kg 2.56 L repairs to be carried out with the minimum of disruption. 25kg 12.5 L. A primer is not required and the mortar will tolerate being applied to a damp substrate.



PRODUCT CODE	PRODUCT DESCRIPTION	PRODUCT SIZE
NUF083	Epicon F.S. Mortar 5 Kg	5 Kg
NUF084	Epicon F.S. Mortar 25 Kg	25 Kg

Epoxy Bearing Mortar

Epoxy bridge bearing mortar. Designed 18Kg 8.35 L specifically for bridge bearing pad levelling plinths and other load bearing applications. Develops high strengths quickly even at low temperatures. Used in conjunction with Epicon Primer/Tack Coat 'H'.



PRODUCT CODE	PRODUCT DESCRIPTION	PRODUCT SIZE
NUF090	Epibear	18 Kg

Tack Coat H

Epoxy primer / tack coat. A solvent free system used on vertical and horizontal surfaces. Can be applied to damp surfaces. Use with Resiset, Epicon and Epibear mortar systems.



PRODUCT CODE	PRODUCT DESCRIPTION	PRODUCT SIZE
NUF094	Epicon Tack Coat H	1 Kg

PROTECTIVE COATINGS FOR CONCRETE

Covercrete

Anti Carbonation Coatings

Anti-carbonation coating which also provides a highly durable weather resistant surface. This water based protective coating is available in a range of attractive colours.



PRODUCT CODE	PRODUCT DESCRIPTION	PRODUCT SIZE
NUF022	Covercrete	5 Litres

Nucryl

Clear anti-carbonation coating. A solvent borne acrylic treatment with excellent resistance properties that protects substrates from aggressive atmospheric contaminants.



PRODUCT CODE	PRODUCT DESCRIPTION	PRODUCT SIZE
NUF044	Nucryl	5 Litres

Epigard

Epoxy Waterproofing Coating

Heavy duty and flexible waterproof coating protective coating for concrete and steel structures. Resistant to abrasion and chemical attack.

Protecting concrete structures including, abutments, drainage channels, silage pits & tanks.

Product Advantages:

- Long term protection
- Easily installed by brush or roller
- Resistant to agricultural and silage effluent
- Excellent mechanical abrasion resistance.



PRODUCT CODE	PRODUCT DESCRIPTION	PRODUCT SIZE
NUF032	Epigard	5 Kg

Nuproof

Bitumen Waterproofing Coating

Alkali resistant rubberised bituminous coating with excellent adhesion to sound building materials including asphalt surfaces. Flexible at low temperatures and resists softening. Ideal as a flexible waterproof membrane on bridge abutments and external walls prior to backfilling.



PRODUCT CODE	PRODUCT DESCRIPTION	PRODUCT SIZE
NUF047	Nuproof	25 Litres
NUF048	Nuproof	200 Litres

Blockseal Standard

Resin Based Block Paving Sealer.



PRODUCT CODE	PRODUCT DESCRIPTION	PRODUCT SIZE
NUF101	Blockseal Standard	25 Litres

CHEMICAL RESIN ANCHOR

Resicon 3

Resicon 3 comprises a high-performance rapid curing styrene free low odour chemical injection anchoring system based on modified epoxy acrylate resin. Primarily designed for heavy duty bonding of anchor studs, bolts, threaded bars sockets, rebar starter bars and dowels into reinforced and non-reinforced concrete rock and stone.



PRODUCT CODE	PRODUCT DESCRIPTION	PRODUCT SIZE
RES001	Resicon 3 – 345 ML	Each
RES002	Resicon 3 – Applicator Gun	Each
RES004	Resicon Replacement Nozzle	Each

Resicon 5

Resicon 5 is a premium grade high-performance solvent free low odour pure epoxy resin based chemical injection anchoring system. As a pure epoxy resin Resicon 5 offers excellent adhesion to steel and concrete and has the highest performance and load values of all our systems. Resicon 5 is designed for heavy duty anchoring of rebar, starter bars and dowels, anchor studs, bolts, threaded bars and sockets into reinforced and non-reinforced concrete rock and stone. Its non-shrink no sag extended cure time formula makes it ideal for large diameter deep and oversized drill holes. Suitable for use underwater and in submerged holes.



PRODUCT CODE	PRODUCT DESCRIPTION	PRODUCT SIZE
RES020	Resicon 5 – 400 ML	Each
RES022	Resicon 5 – Applicator Gun	Each

JOINT SEALANTS

Hyperseal Expert 150

One Component Polyurethane

Hyperseal® – Expert – 150 is a novel low modulus expansion joint sealant, especially formulated to ensure bubble free cure even at very high temperature and humidity climatic conditions.

Recommended for sealing joints in; Insitu concrete, expansion concrete plates, precast panels, brick and block work, water tanks and swimming pools, metal frames, aluminium windows and panels, irrigation channels, glass, granite & marble.

Colour: Concrete Grey as standard. (Other colours available on request).



PRODUCT CODE	PRODUCT DESCRIPTION	PRODUCT SIZE
PLS012	Hyperseal 150 Expert Grey 600cc	Each / 15 Per Box

Microprimer PU

One component, low viscosity, 100% aliphatic polyurethane based primer suitable for all substrates.



PRODUCT CODE	PRODUCT DESCRIPTION	PRODUCT SIZE
PLS030	Micro Primer PU 1 Litre	Each

Two Component Polysulphide Sealant

Pouring Grade is a two part Polysulphide Sealant which cures once the two components are mixed together to give a flexible rubber seal. It has good adhesion to concrete, metals and many other common building substrates.



Gun Grade is a two part Polysulphide Sealant which cures once the two components are mixed together to give a flexible rubber seal. It has good adhesion to concrete, stone, metals and many other common building substrates. Recommended for sealing structural floor joints, parapet wall joints, concrete roadways and pavements, hard standing floor pads, joints in metal and concrete sea walls and joints in water retaining (non drinking water) structures.

PRODUCT CODE	PRODUCT DESCRIPTION	PRODUCT SIZE
ARB010	Arbokol AG2 Pouring Grade 5 L (Grey)	5 Litres
ARB011	Arbokol AG2 Gun Grade	5 Litres
ARB030	Arbokol Porous Primer – 5 Ltr	5 Litres

Uniseal 200/90

Uniseal 200/90 Sealant is a pitch free high performance two-part elastomeric sealant specifically developed for sealing contraction and expansion joints in airfield runways, taxiways, hard standings and fuelling areas. It can accommodate above average movement and severe climatic conditions.



PRODUCT CODE	PRODUCT DESCRIPTION	PRODUCT SIZE
NUF063	Uniseal 200/90 Black	5 Litres

Porous Primer

One part, solvent containing, air-drying isocyanate resin-based primer.



PRODUCT CODE	PRODUCT DESCRIPTION	PRODUCT SIZE
ARB031	Porous Primer	5 Litres

Uniseal Primer P2

Moisture curing solvent borne polyurethane primer.
A versatile single component penetrating primer for use with epoxy and polyurethane systems. Designed for the treatment of porous substrates prior to the application of protective/technical performing coatings.



PRODUCT CODE	PRODUCT DESCRIPTION	PRODUCT SIZE
NUF068	Uniseal Primer P2	1 Litre

Bituseal

Bituseal joint sealants are hot poured thermoplastic bitumen rubber joint sealants designed for use in sealing horizontal movement joints in concrete pavements, floor slabs and asphalt surfaces.

Standards Compliance: BS 2499: 1973 and BS 6920: 1988.



PRODUCT CODE	PRODUCT DESCRIPTION	PRODUCT SIZE
NUF004	Bituseal	20 Kg

APPLICATOR SPRAYERS & GUNS

Jointsealant Applicator Gun

Applicator Gun to suit Hyperseal Expert 150.



PRODUCT CODE	PRODUCT DESCRIPTION	PRODUCT SIZE
PLS020	Applicator Gun	Each

Cleaning Agent

A powerful solvent cleaner used to clean all tools and equipment which have been in contact with resin-based materials.



PRODUCT CODE	PRODUCT DESCRIPTION	PRODUCT SIZE
NUF054	Nuwash	5 Litres

SCP TANKING MEMBRANES

Bitusheet XL

Self Adhesive Waterproofing Membrane

Bitusheet XL membrane consists of a self-bonding polymer modified bitumen which is covered on one side by a tough multiply cross laminated polythene film and protected on the other side by a release sheet which is removed prior to the bonding of the material onto a suitably prepared substrate. Once the release sheet has been removed the membrane can be easily applied by roller pressure. Incorporates a 50mm selvedge on one edge to form homogenous overlap joints. Bitusheet XL is intended for use as a self-bonding vertical or horizontal damp proof membrane in tanking below ground structures, subways and retaining walls. BBA Approved.



PRODUCT CODE	PRODUCT DESCRIPTION	PRODUCT SIZE
WPF020	Bitusheet XL 19.05 x 1.05 m	20 Pallet
WPF021	Bitusheet XL Tape 100mm x 20 m	10 per Box
WPF024	Bitusheet XL Strip 300 mm x 20 m	3 Per Box
WPF025	Bitusheet Protection Board 2 x 1 mt	2 x 1 Metre
WPF022	Bitusheet Primer	5 Litres

Dual Seal Membrane

Self Sealing Membrane

Dual seal is a high performance self-swelling, self-healing waterproofing membrane comprising of a thick, tough, high density polyethylene sheet laminated to 4Kg/m2 of quality Bentonite granules. The Bentonite used in the manufacture of Dual Seal is capable of repeated cycles of wetting and drying without deterioration of its sealing properties and has a life expectancy measured in thousands of years (BBA Certified). It has WRAS approval for use with potable water.

Dual Seal has been specifically developed for use as a high-performance waterproofing membrane to provide a totally watertight barrier in below ground concrete construction, including basements, underground car parks, plant rooms, access tunnels etc. Dual Seal Membrane can be installed in damp conditions and is, therefore particularly suitable for use as a roof waterproofing system for each covered potable water reservoirs.



PRODUCT CODE	PRODUCT DESCRIPTION	PRODUCT SIZE
WPF010	Dual Seal Roll 1.22 x 7.32 Metres	Per Roll
WPF011	LG Dual Seal Roll – 1.22 x 7.32 Metres	Each
WPF012	Dual Seal Mastic Tub 23 Kg	23 Kg

Hyperdesmo-HAA

Polyurethane Liquid Membrane



Hyperdesmo® – HAA is a unique single component polyurethane liquid membrane, based on the successful combination of Hyperdesmo® and Accelerator 3000 which throughout the years has provided applicators with a solution for a fast curing, bubble free thick layer membrane. Our commitment to R&D and investment and our efforts to continuously upgrade our chemical processing plant has allowed us to formulate a Hyperdesmo® with the Accelerator 3000 incorporated in a blocked fashion, that upon contact with humidity is released and self-accelerates the curing of the material in a similar manner as the Accelerator 3000.

Due to its unique formulation, it cures rapidly to form a completely defect free membrane with excellent mechanical and elastomeric properties. This product is ideal for use during the winter months or in climates with relatively low humidity. Furthermore, the fact that the minimum consumption can now be achieved in only one coat, reduces labour cost and eliminates previous drawbacks of the Hyperdesmo® + Accelerator system such as short working time or problems associated with using Hyperdesmo® on its own in multilayer coats adhesion failure.

PRODUCT CODE	PRODUCT DESCRIPTION	PRODUCT SIZE
PLA037	Hyperdesmo HAA Grey	25 Kg
PLA038	Hyperdesmo HAA Grey	15 Kg
PLA039	Hyperdesmo HAA Grey	6 Kg
PLA039A	Hyperdesmo HAA Grey	0.5 Kg
PLA039B	Hyperdesmo GAA White	6 Kg

Isostud Geop

Protection & Drainage Membranes



Isostud Geop is a high density extruded polyethylene (HDPE) membrane bonded to a high quality geotextile fabric providing both drainage and mechanical protection of waterproof membrane.

Isostud Geop is a studded membrane which offers great resistance to all chemical agents and to mechanical compression (>200 KN/m2). Isostud can also be used for terraces, flat roofs and roof gardens. The studs are aligned along vertical and horizontal axis: water can easily and rapidly drain from the top to the bottom of the foundation (whereas HDPE membranes with studs diagonally aligned do not offer this advantage and water drains slowly).

PRODUCT CODE	PRODUCT DESCRIPTION	PRODUCT SIZE
TEM001	Isostud Geop 2 x 20M	20 Metre Rolls

Aquatek Plug & Aquatek Plug XF



Rapid Setting Mortar to plug active water leaks

Stops active water leaks and seepage, even under high pressure through joints, cracks, honeycombing and holes in all structures made out of concrete, masonry, stone and renders.

Aquatek Plug has a final setting time of 3 minutes and Aquatek Plug XF of 30 seconds.

PRODUCT CODE	PRODUCT DESCRIPTION	PRODUCT SIZE
DNF001	Aquatek Plug XF	10 Kg
DNF003	Aquatek Plug	10 Kg

WATERSTOPS

Bentonite Swelling Tape

Masterstop Bentostrip swelling tape used for reliable waterproofing of construction joints as well as penetrations in concrete structures against water penetration. The swelling of the tape and the swelling pressure developed during the swelling process prevent water penetration.



PRODUCT CODE	PRODUCT DESCRIPTION	PRODUCT SIZE
WPF003A	Masterstop Bentonite Swelling Tape 25 x 20 mm Black	30 Metres per Box
WPF004A	Bentonite Swelling Tape Steel Grid 25 x 20 mm	30 Metres per Box

Hydrophillic High Pressure Swelling Tape

Flowstop high pressure swelling tape is used for safe waterproofing of construction joints and penetrations in concrete structures. The swelling and the swelling pressure that form during the swelling process prevent the ingress of water.



PRODUCT CODE	PRODUCT DESCRIPTION	PRODUCT SIZE
WPF002A	Flowstop High Pressure Swelling Tape 20 x 10 mm Red 10 m per Roll	10 metres per Roll
WPF014	Flowstop Adhesive	1 Cartridge / 8m

Metal Water Stop

Polymer-coated joint sheet metals for waterproofing of construction joints. The packaging in rolls reduces joints and therefore increases installation reliability. The rolls are packed in cartons, the handling on the building side is easier and so is the transportation.

In the waterproofing of concrete construction joints high demands are placed on the waterproofing technology. The fully coated joint sheet metal 160 VB waterproofing profiles ensure secure and permanent waterproofing against pressurised and non- pressurised water.



PRODUCT CODE	PRODUCT DESCRIPTION	PRODUCT SIZE
FRA001A	Metal Water stop on a roll VB1 160	20 m roll x 36/ 720 m on a pallet

Self Adhesive Bentonite Swelling Tape 20 x 5mm

MASTERSTOP SK for reliable waterproofing of construction joints as well as penetrations in concrete structures against water penetration. The swelling of the tape and the swelling pressure developed during the swelling process prevent water penetration.



PRODUCT CODE	PRODUCT DESCRIPTION	PRODUCT SIZE
WPF015	Masterstop SK20 x 5	Metre/90 m Carton

PVC Waterstop

Floor, Wall & Joints

A specifically designed PVC high performance waterstop suitable for both internal and external use. Specifically developed to seal joints (watertight) in concrete structures which protects the reinforcing steel against corrosion attack.



PRODUCT CODE	PRODUCT DESCRIPTION	PRODUCT SIZE
WPF050	PVC Waterstop External (Floor) 200 mm	15 Metre Roll
WPF051	PVC Waterstop Internal (Wall) 200 mm	15 Metre Roll
WPF071	PVC Waterstop Internal (Wall) 250 mm	15 Metre Roll
WPF070	PVC Waterstop External (Floor) 250 mm	15 Metre Roll

PVC Waterstop Joint Junction Pieces

We supply a variety of PVC Waterstop Junction Pieces. Contact us for assistance.

PRODUCT CODE	PRODUCT DESCRIPTION
WPF052A	200 mm INT FLAT 'L'
WPF053	200 mm EXT FLAT 'L'
WPF054	200 mm EXT VERTICAL 'L'
WPF055	200 mm INT VERTICAL 'L'
WPF056	200 mm INT/EXT MIXED VERTICAL 'L'
WPF057	200 mm EXT REVERSE VERTICAL 'L'
WPF058	200 mm EXT/INT MIXED VERTICAL 'T'
WPF059	200 mm EXT FLAT 'T'
WPF060	200 mm INT FLAT 'T'
WPF061	200 mm EXT FLAT 'X'
WPF062	200 mm INT FLAT 'X'
WPF063	200 mm INT VERT 'T'

PRODUCT CODE	PRODUCT DESCRIPTION
WPF064	200 mm EXT VERT 'T'
WPF072	250 mm INT/EXT MIXED VERTICAL 'L'
WPF073	250 mm EXT VERTICAL 'L'
WPF074	250 mm INT VERTICAL 'L'
WPF075	250 mm EXT FLAT 'T'
WPF076	250 mm EXT FLAT 'X'
WPF077	250 mm INT FLAT 'T'
WPF078	250 mm INT FLAT 'L'
WPF079	250 mm EXT FLAT 'L'
WPF080	250 mm INT/EXT MIXED VERTICAL 'T'
WPF081	250 mm INT FLAT 'X'

EXT = External INT = Internal

BESPOKE WATERSTOP JOINTS AVAILABLE ON REQUEST

INTERNAL WALL JOINTS



EXTERNAL FLOOR JOINTS

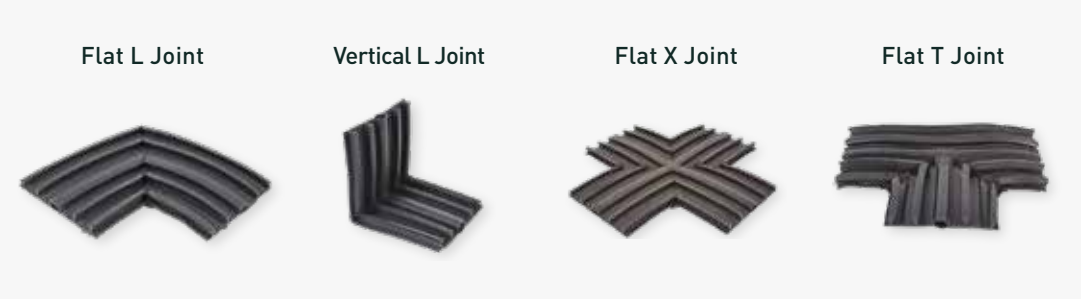

MIXED INTERNAL / EXTERNAL JOINTS

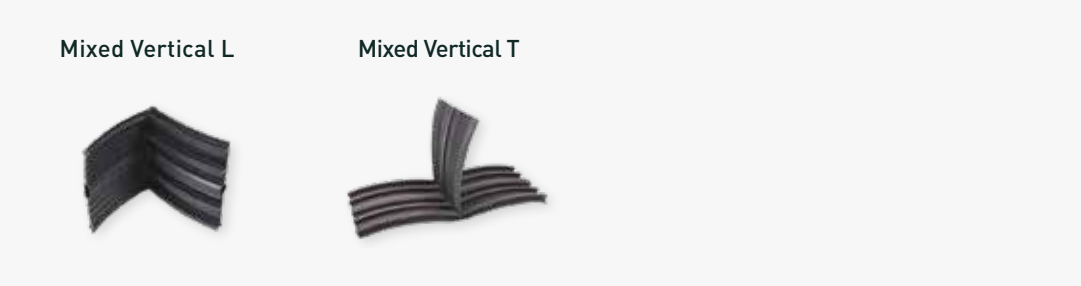

Compression Joint Seal: TOKSTRIP®

A plastic seal for manhole components and special profiles made of concrete. Thanks to the combination of bitumen, butyl rubber and other innovative components, as well as the self-adhesive, one-sided coating, the seal profile fits to the existing geometries, compensates for any unevenness in the component and adheres very well to the contact surfaces.



PRODUCT CODE	PRODUCT DESCRIPTION	PRODUCT SIZE
KOS005	TOKSTRIP® 25 x 20 mm 20 per box	5 Metre Roll
KOS010	TOKSTRIP® 40 x 20 mm 15 per box	3 Metre Roll
KOS013	TOKSTRIP® 60 x 12 mm 24 per box	24 Metre Box
KOS014	TOKSTRIP® 80 x 12 mm 18 per box	15 Metre Box

Active Ring

Swelling TPE Seal for Tubing

Swelling external high-pressure seal for distance tubes. The Active Ring mini/maxi, made of TPE (thermoplastic elastomer), is used for a simple and reliable external waterproofing of plastic and fibre cement distance tubes. The swelling and the swelling pressure that forms during the swelling process prevents the ingress of water.



PRODUCT CODE	PRODUCT DESCRIPTION	PRODUCT SIZE
WPF400	Active Ring Mini 22 mm	250 per Bag
WPF041	Active Ring Maxi 26 mm	250 per Bag

CONCRETE TESTING EQUIPMENT

150MM 4 PART STEEL MOULD CUBE



100MM DOUBLE PLASTIC MOULD CUBE



BASE PLATE



SCOOP



SLUMP CONE



PLASTIC CURING TANK FOR SITE USE



TAMPING ROD



PRODUCT CODE	PRODUCT DESCRIPTION	PRODUCT SIZE
TST001	Concrete Mould Cube Steel 150 mm	Each
TST002	Concrete Mould Cube Steel 100 mm	Each
TST005	Concrete Mould Cube Plastic 100 mm Double	Each
TST010	Slump Cone	Each
TST011	Tamping Rod	Each
TST012	Tamping Bar Square	Each
TST013	Cube Mould Scoop 4.5 Kg	Each
TST014	Base Plate	Each
TST020	CN059 – Curing Tank Plastic for Site 240v	Each

Tape

Mammoth Builders PVC tape is a strong tape with versatile adhesive ideal for jointing all PVC and polythene sheets and membranes.

Ideal for contamination barrier fastening, dust sealing of sheets and many other uses in the construction industry.



PRODUCT CODE	PRODUCT DESCRIPTION	PRODUCT SIZE
	Black tape	50 mm x 33 Metres

Barrel Taps

Economical, chemical-resistant Tap works with many liquids. Available in Small & Large



PRODUCT CODE	PRODUCT DESCRIPTION	PRODUCT SIZE
FWK141	Small Barrel Tap	Each
FWK141B	Large Barrel Tap	Each

FORMWORK SOLUTIONS

recostal® Speed Edge Formwork

recostal® Speed Edge Formwork is made from galvanised sheet metal and is used for shuttering base and floor slabs.

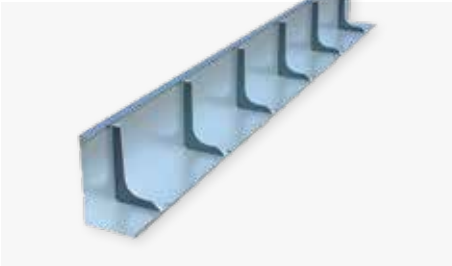

PRODUCT CODE	PRODUCT DESCRIPTION	PRODUCT SIZE
FWK370	recostal® Speed edge Formwork: 180 x 2250 mm	Per Metre
FWK371	recostal® Speed edge Formwork: 200 x 2250 mm	Per Metre
FWK372	recostal® Speed edge Formwork: 250 x 2250 mm	Per Metre
FWK373	recostal® Speed edge Formwork: 300 x 2250 mm	Per Metre

recostal® Permanent Formwork System

Shuttering units comprised of finely meshed, trapezoidally-profiled, expanded metal, designed for creating construction joints in concrete base slabs. Units are supplied to specific project-heights on site. recostal® shuttering is also available with anti-leakage material and clamps to eliminate the need to weld rebars.

For the installation of permanent lateral formwork for reinforced concrete base and floor slabs in structural and civil engineering.



Features include:

- self-supporting up to 50cm height
- no additional support necessary
- no stripping
- fast installation
- corners are simply bent into shape
- low transport costs
- installation without crane.

Range available includes:

- recostal® 1000 – for concrete slabs up to 300 mm of wet concrete
- recostal® 2000 – for concrete slabs up to 900 mm of wet concrete
- recostal® 2000 GT – for concrete slabs up to 1500 mm of wet concrete
- recostal® 2000 GTZ – for concrete slabs over 1500 mm of wet concrete.

For more information and to discuss site specific requirements please contact our office.

recostal® Shutter Strips

Shuttering Strips facilitate quick and easily installed openings of all sizes in base slabs and concrete floors. Shuttering Strips are perforated crosswise at every 50mm. The scaled profile ensures a good bond to the concrete.



PRODUCT CODE	PRODUCT DESCRIPTION	PRODUCT SIZE
CNT100	recostal® Shuttering Strip – Type SF	16 Metre
CNT101	recostal® Shuttering Strip – Type SF	20 Metre
CNT102	recostal® Shuttering Strip – Type SF	25 Metre
CNT103	recostal® Shuttering Strip – Type SF	30 Metre

MASONRY REINFORCEMENT

Murfor® Compact

Murfor® Compact is the next generation of Masonry Reinforcement on a roll. Available in stainless steel and galvanised it can be used on both internal and external walls; it is easily rolled out onto masonry joints reducing install time making the building process quicker.

CE and ETA approved due to its design it is the first product to market which is used for both structural and crack control.



PRODUCT CODE	PRODUCT DESCRIPTION	PRODUCT SIZE
MUR001	Murfor Compact Internal I50	30 Metres per Roll
MUR002	Murfor Compact Internal I00	30 Metres per Roll
MUR003	Murfor Compact External E35	30 Metres per Roll
MUR004	Murfor Compact External E70	30 Metres per Roll

Stucanet®

Render Carrier

Stucanet is a purpose designed plater and render carrier which is manufactured from heavy galvanised steel welded wire mesh into moisture absorbent chip paper. It is used specifically for exterior façade applications and is protected with a breather membrane to prevent moisture penetration.



Applications:

- Stucanet® is used specifically for exterior facade applications.
- Stucanet® can be used on a Masonry wall or Timber frame.
- Available in Stainless Steel or Galvanised.

Key Benefits:

- Quick and easy install
- Durable plasterwork and rendering
- Can be used as a dry wall alternative
- CE Complaint
- No need to remove existing render

Acoustic Insulation Layer

Application Sector

DAMTEC® rubber is a floor underlay for footfall sound reduction and thermal insulation; used in building construction and renovation. Suitable for underscreed applications and can also be used above screed especially in wet rooms under ceramic tiles.

Material: Fine granules of recycled rubber with PU elastomer bonding agent.

Appearance: Colour – Black. Surface – Fine granular texture.



TECHNICAL DATA		
Dimensions/Tolerances		
Width:	1,000 mm	± 1.5 %
Length:	on request	± 1.5 %
Available thickness:	3, 4, 5 and 6 mm	± 0.3 mm
Density:	approx. 800 kg/m³	
Physical Characteristics		
Tensile strength:	approx. 0.6 N/mm²	(ISO 1798)
Elongation at break:	approx. 60%	(ISO 1798)
Service temperature range:	- 30°C to 80°C	
Flammability rating:	B 2	(DIN 4102-1)
Heat transmission coefficient:	0.03 m² K/W for 3 mm slab	(DIN 52612)
Impact sound improvement:	ΔL = 20dB without covering	
	ΔL = 17dB under 8 mm tiles	(ISO 140-8/ISO 717-2)

Under Screed Acoustic Solutions

Made from recycled rubber granules. Solutions for constant loads up to 20t/m².

Features and benefits:

- European Technical Approval (CE label)
- Brilliant noise insulation with a low panel thickness
- Outstanding compressive strength and Load-bearing performance permanently elastic
- Highest resiliency even after years of use (does not compress and reduce sound absorption)
- Very low emission
- Water proofed and rot-proofed
- Very environment-friendly, recycled rubber
- Can be recycled again
- Fast and easy installation
- High pressure load capacity
- Elasticity and fast and easy installation low thickness of 4mm to 17mm for low
- Allowing planners to save heights in new buildings or adapt to given conditions in the case of renovation.



Applications:

- Production halls and depots
- Shopping centres
- Concert halls, cinemas
- Fitness centres
- Public buildings
- Schools, training centers
- Recording studios
- Acoustic test laboratories
- Hotels.

PRODUCT	Δ LW	MAX. CONTINOUS LOAD	DYNAMIC STIFFNESS
DAMTEC® estra	≤ 21 dB	0.20 N/mmÇ	≤ 90 MN/mÑ
DAMTEC® estra 3D 8/4	≤ 26 dB	0.10 N/mmÇ	< 20 MN/mÑ
DAMTEC® system	≤ 21 dB	0.05 N/mmÇ	≤ 35 MN/mÑ
DAMTEC® 3D 17/8	≤ 30 dB	0.10 N/mmÇ	< 15 MN/mÑ

Estra 3D 8/4

Impact sound improvement under screed: ≤ 26 db.

Application Sector

DAMTEC® Estra 3D is the ideal rubber underlay in floating screed / concrete slab systems with European Technical Approval, which has been granted by DIBt, the German Center of Competence in Civil Engineering.

Another application is for example underneath rigid floor elements on wooden sub floors. Also as edge strip it can be cut.

DAMTEC® Estra 3D is particularly quick and easy to install and is providing extremely high resistance to compressive loads and outstanding elasticity. It is equally well suited for applications in residential, office and commercial buildings.

Material: Granules of recycled rubber with PU elastomer bonding agent.

Appearance: Colour – Multicolour. Surface – Smooth with granular texturing profiled on one side.

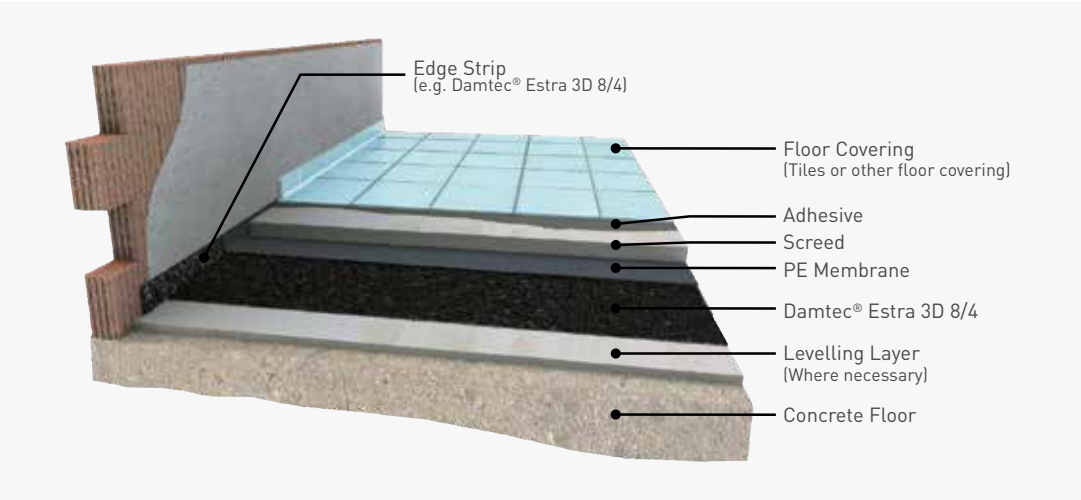

TECHNICAL DATA		
Material	Granules of recycled rubber with PU elastomer bonding agent	
Area weight	3,800 - 4,800 g/m²	
Thickness	8/4 mm	(± 1.0 mm)
Roll width	1,250 mm	(± 1.5 %)
Roll length	on request	(± 1.5 %)
Surface	smooth with granular structure	
Lower side	wave profile	
Colour	black / multicoloured	
Maximum pressure	0.10 N/mm²	(in accordance with EN 826)
Dynamic stiffness	8/4 mm < 20 MN/m³	(EN 29052)
Service temperature range	-30°C up to + 80°C	
Impact sound improvement ΔLW	22dB	(under 50mm screed, 120kg/m²)
	26dB	(under 80mm screed, 179kg/m²)

CONSTRUCTION ACCESSORIES

Still looking for something?

Some of our products apply to multiple sectors. A full breakdown of our product catalogue can be found in the index on page 362.



Still looking for something?

Visit our website for further product information or call our sales team to speak to one of our expert advisors.

WEARESDG.COM
+44 (0) 28 3752 8999







Get in touch

HEAD OFFICE

21 Tullygoonigan Industrial Estate
Moy Road
Armagh
BT61 8DR

Tel: +44 (0) 28 3752 8999

MONAGHAN OFFICE

Cornacrieve
Emyvale
Monaghan
HY18 XY 46

Tel: + 353 (47) 87 295

wearesdg.com

Email: hello@wearesdg.com